

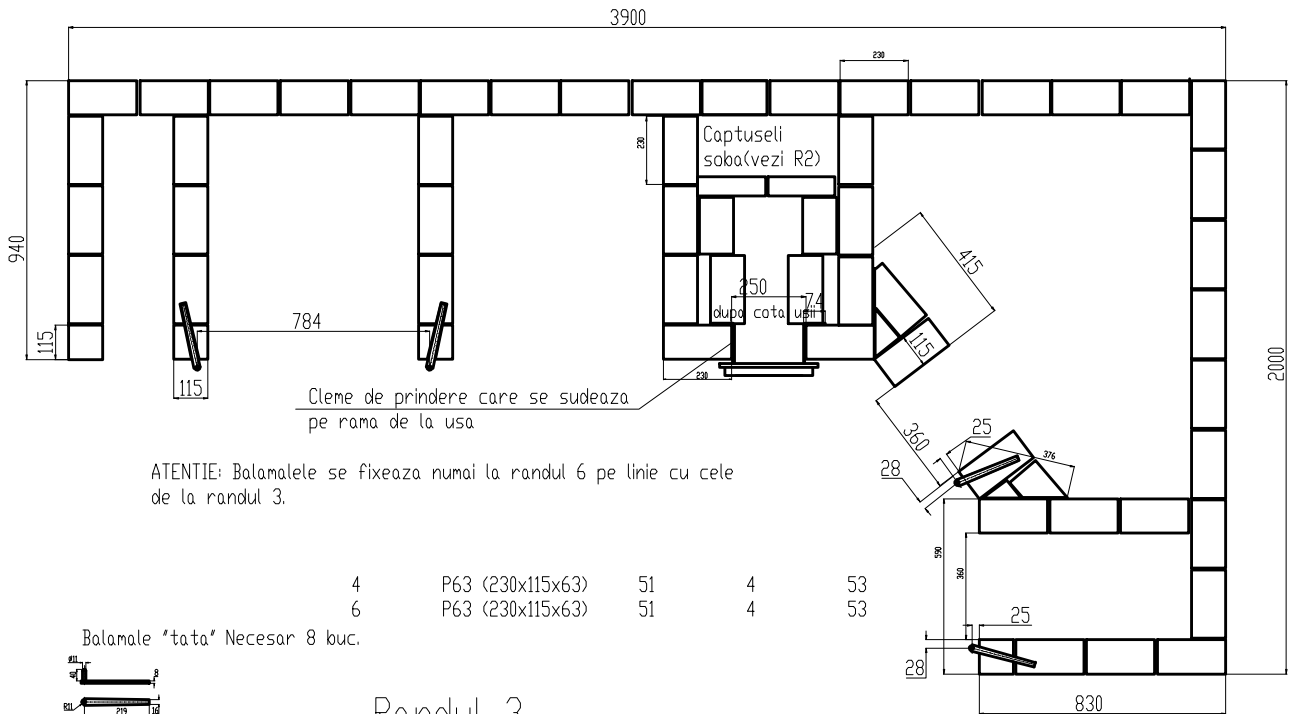



# Randul 4 si 6



# Randul 3

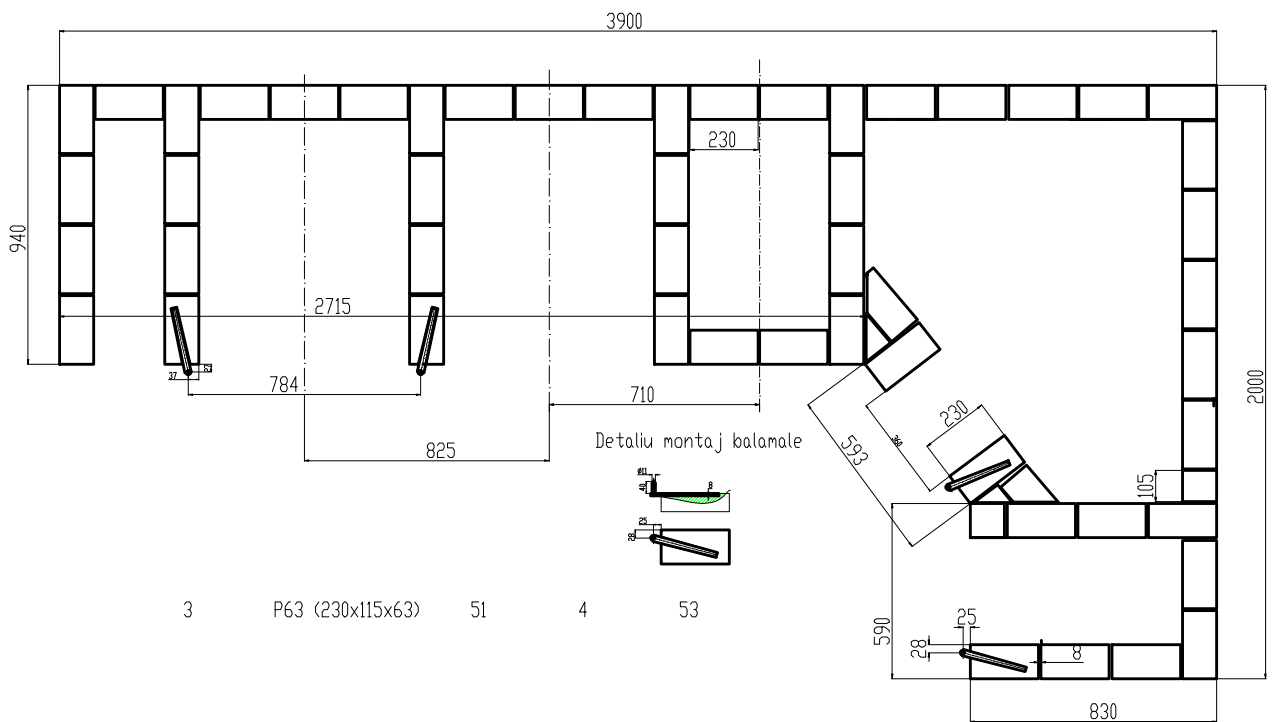

### Randul 7

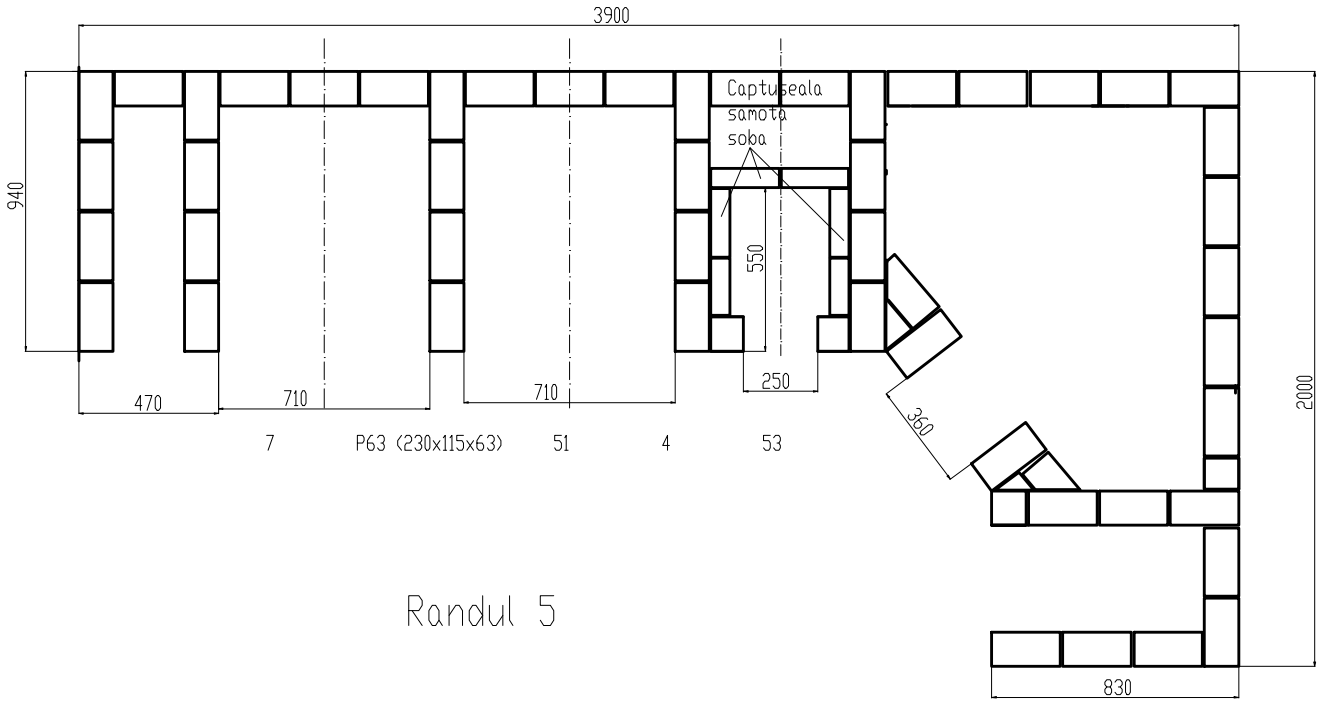

### Randul 5

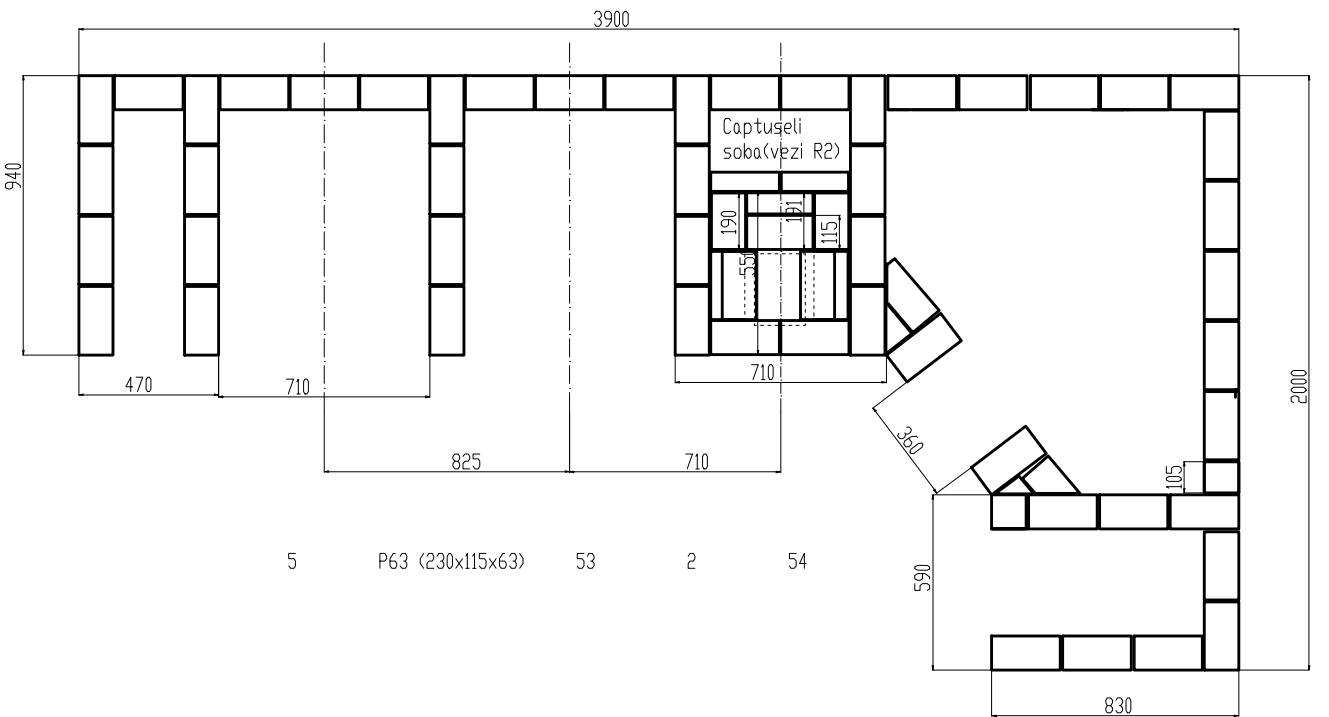





# Randul 10 (fara arcade)

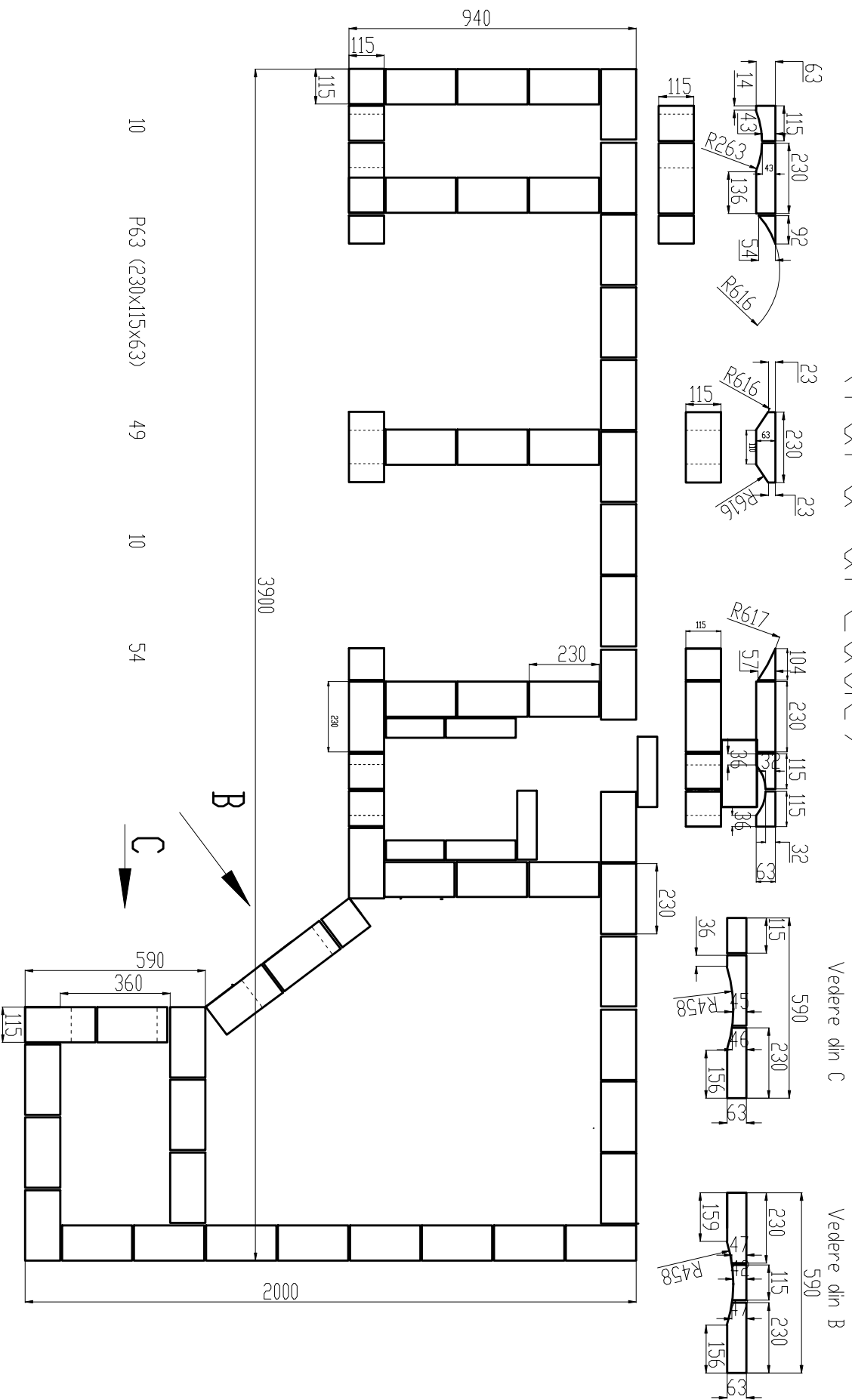

# RANQUU 11

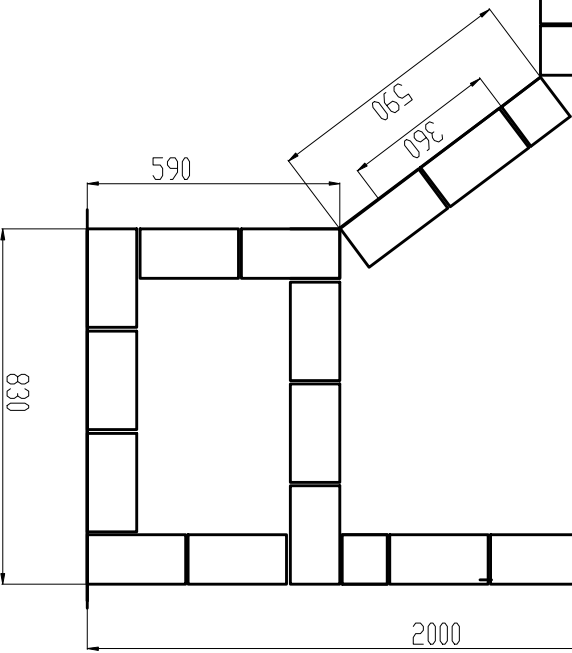
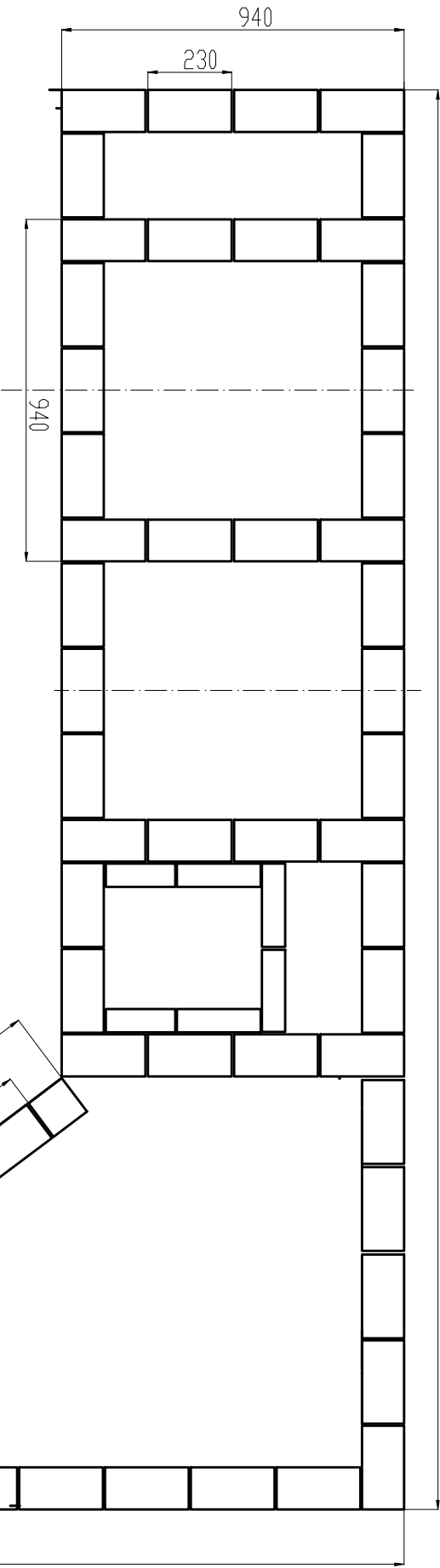
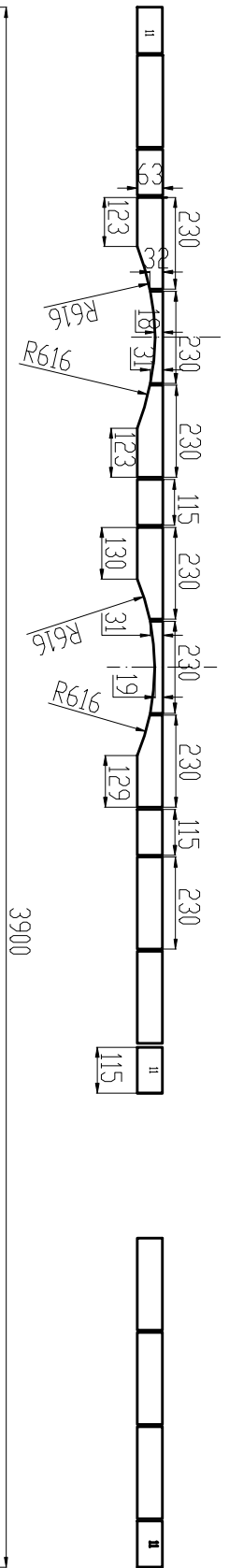

11 P63 (230x115x63) 57 20 58









A-A (rotita)

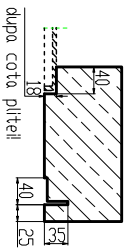

Nota: Decuparea pentru pila 40x18) se executa numai la 3 caramizi iar pentru cornier la toate cele 7 buc. din rand.

# Randul

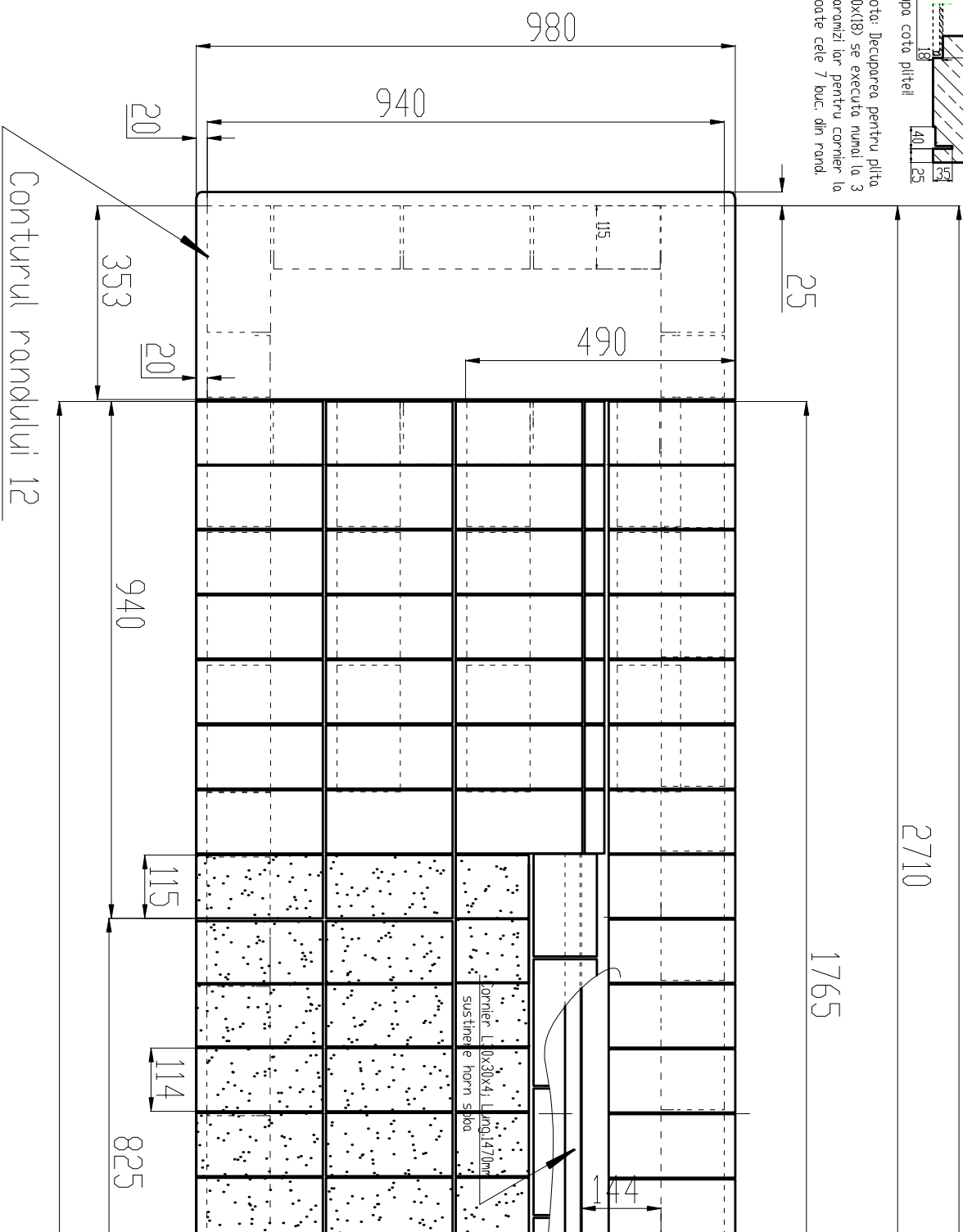

NOTA: Caramizile din zona 710x613 sunt din samot  
Pe randul 12 se monteaza placile de marmu



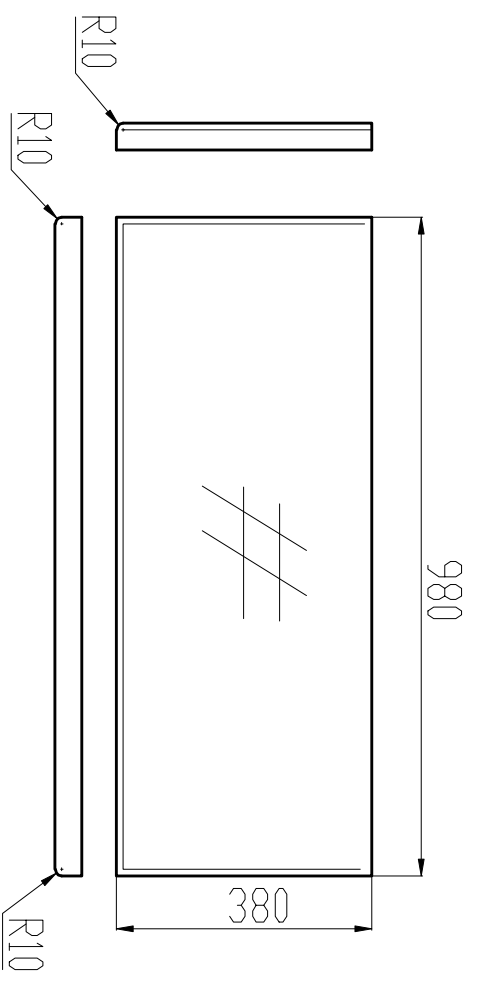

Nota: Placa se traseaza dupa executarea rindului 13 lasand o margine corespunzatoare fata de rindurile inferioare.

decupare pt. chiuveta

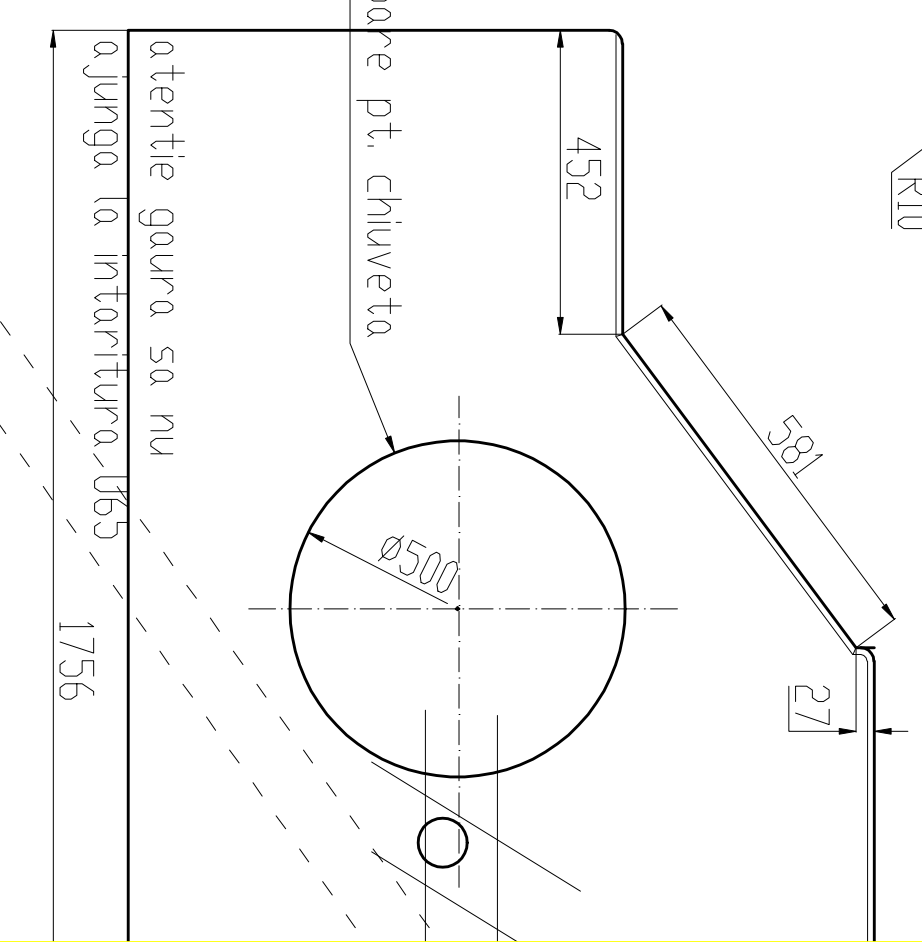

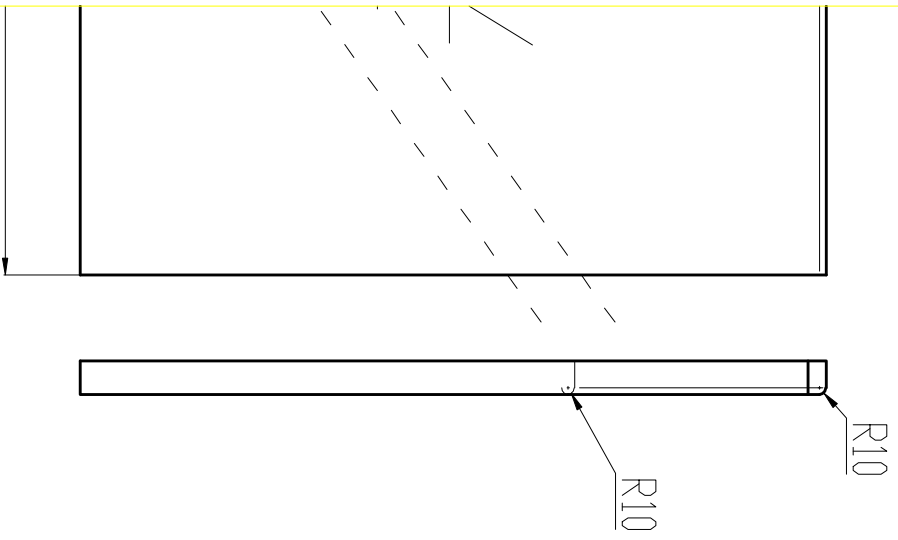
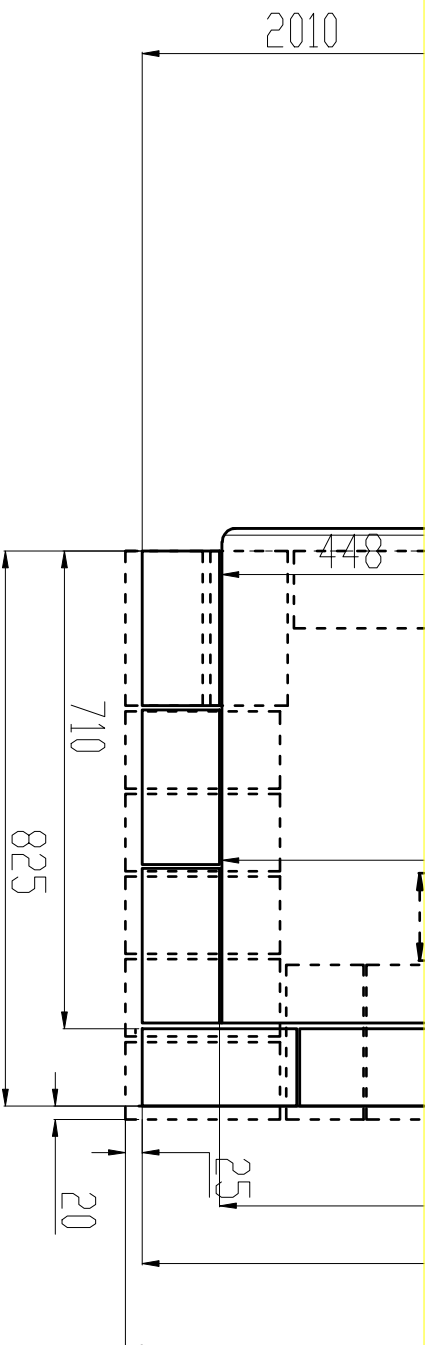

13	P63 (230x115x63)	68	2	69
	R-28 AS (230x114x64)	12	6	15

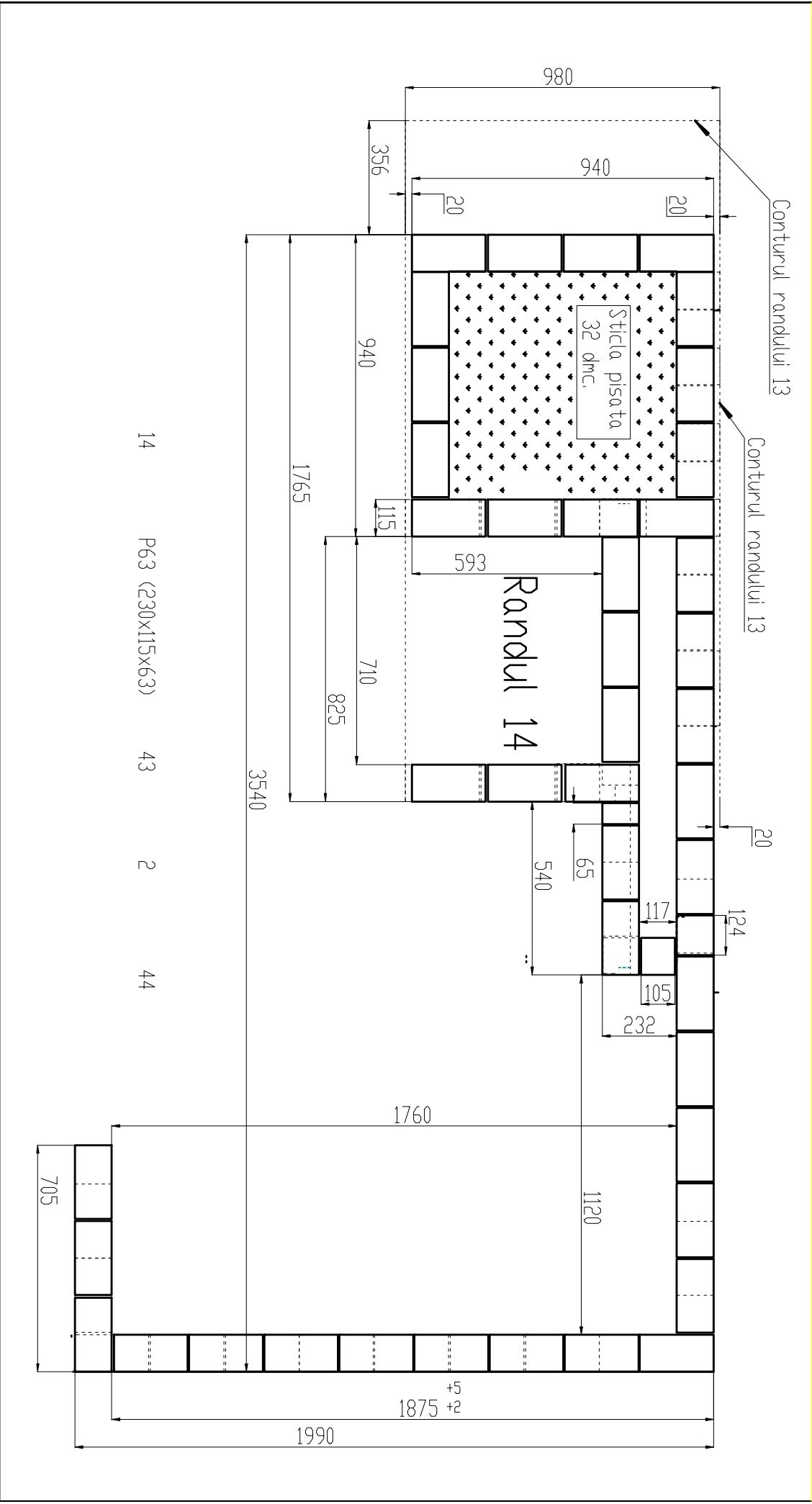

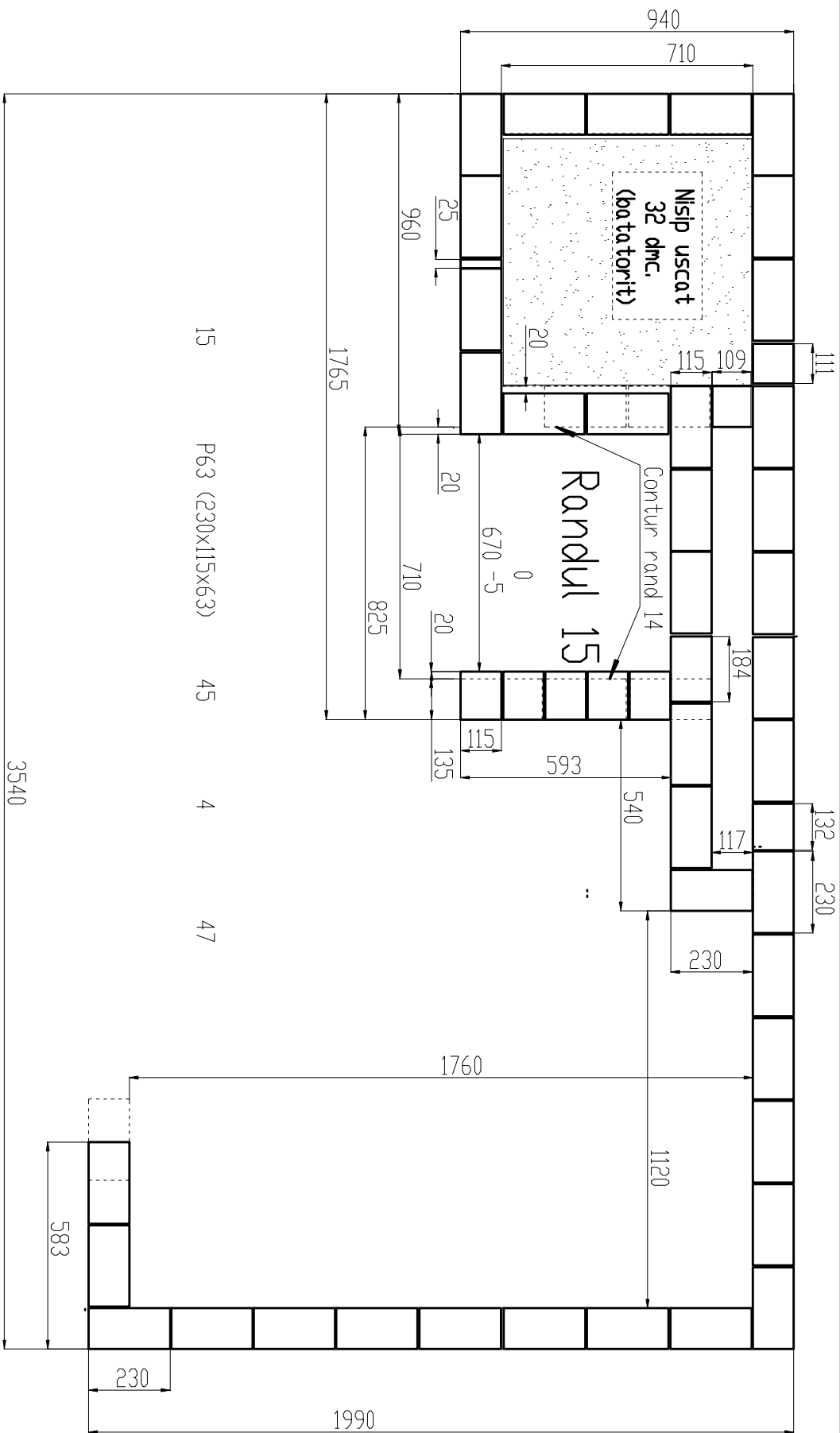





Detaliu montaj rama usa  
cuptor pizza

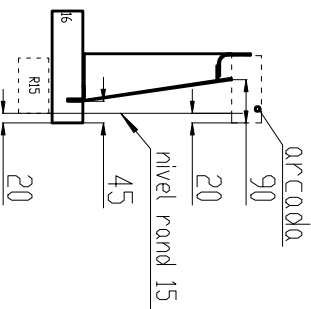
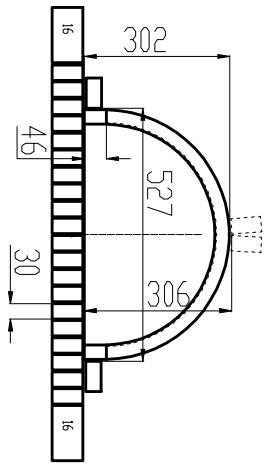

Talere caramizi sub  
rama usii 20 buc.

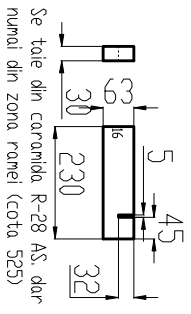

Se tale din caramida R-28 AS, din  
numai din zona ramei (cota 525)

ANSAMBLU USA

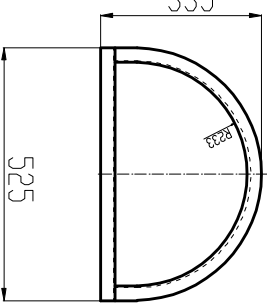
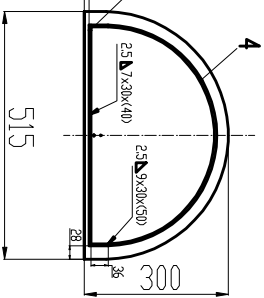
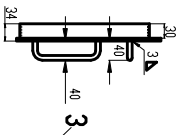
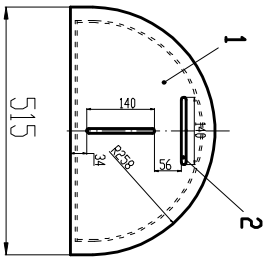

ANSAMBLU RAMA

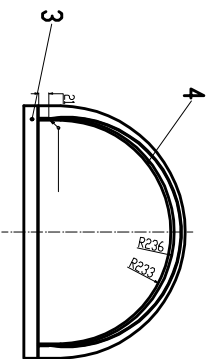
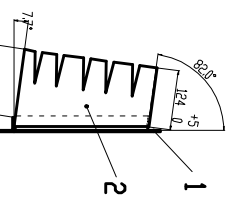

Nota: Arcada se construiește după usa, cu  
această montată

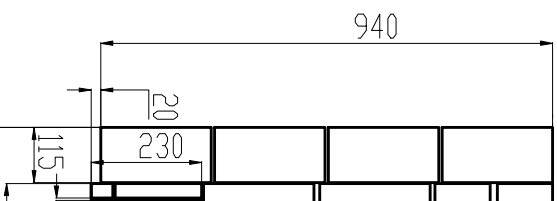

Detaliu montaj rama usa  
cuptor pizza

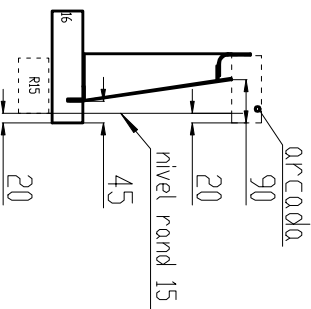
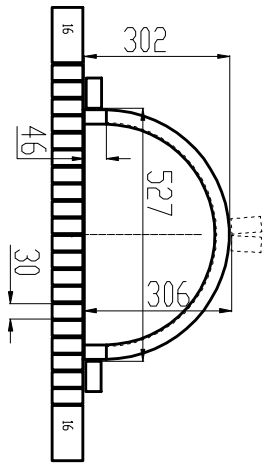

Talere caramizi sub  
rama usii 20 buc.

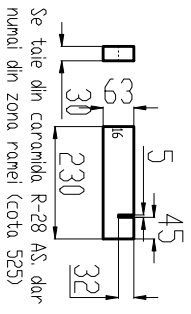

Se foloseste caramida R-28 AS, din  
numai din zona ramei (cota 525)

ANSAMBLU USA

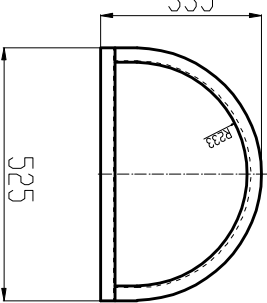
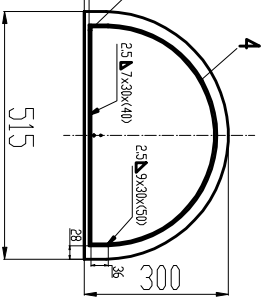
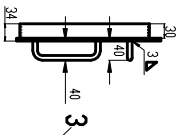
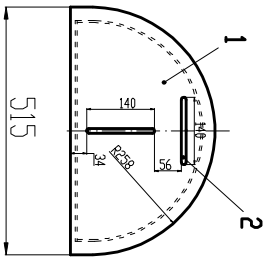

ANSAMBLU RAMA

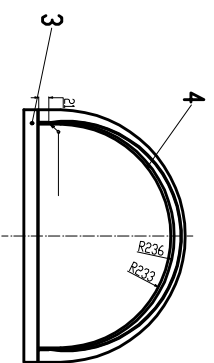
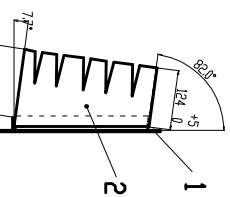

Nota: Arcada se construiește după usa, cu  
această montată

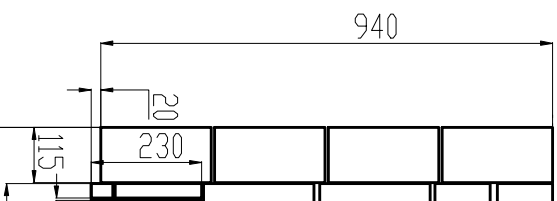



# Randul 18

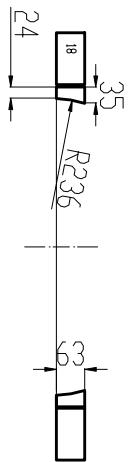

3540

18

P63 (230x115x63)

38

4

40

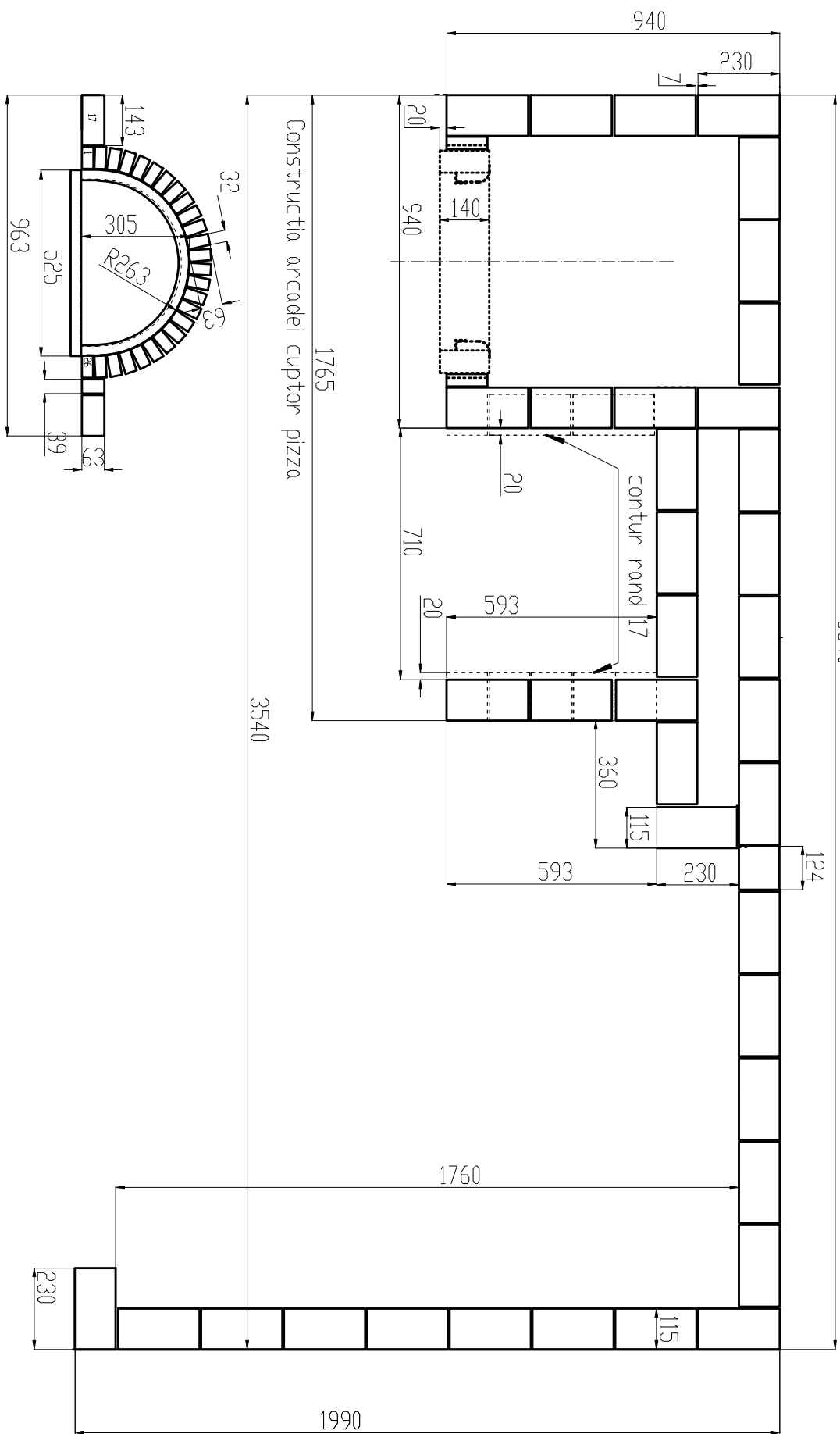

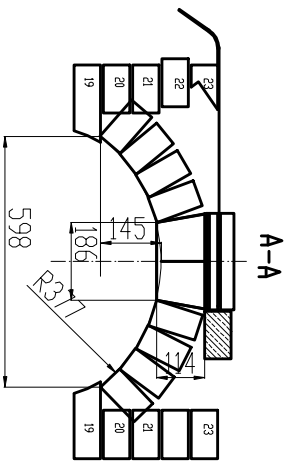

# Randul 19

19	P63 (230x115x63)	41	6	40
	R-28 AS (230x114x64)	33		33
	R 32 -28AS (230x114x32)	4		4

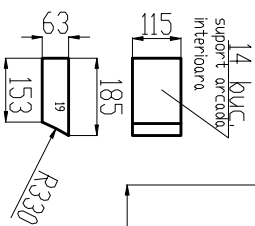
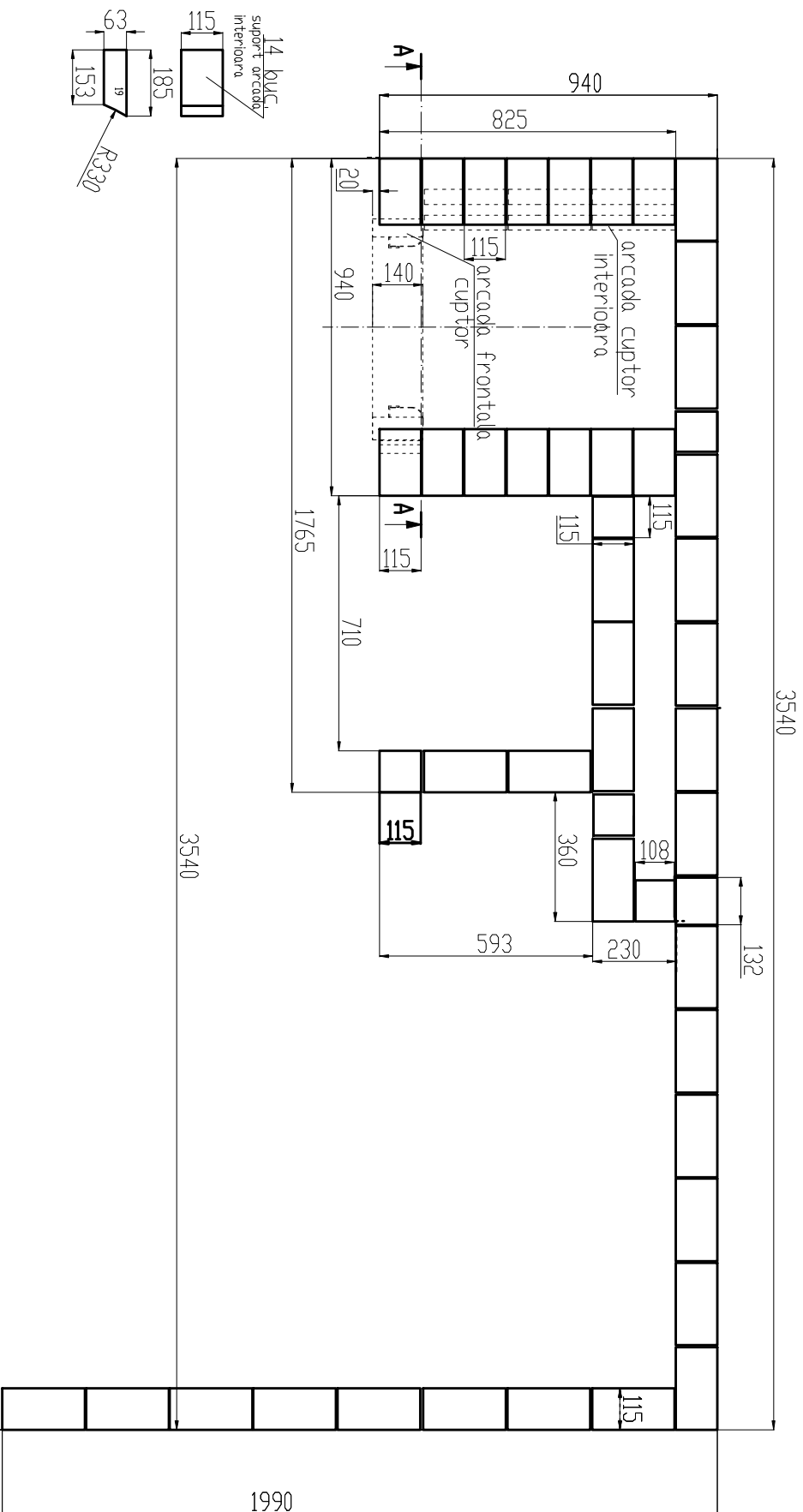

# Randul 20

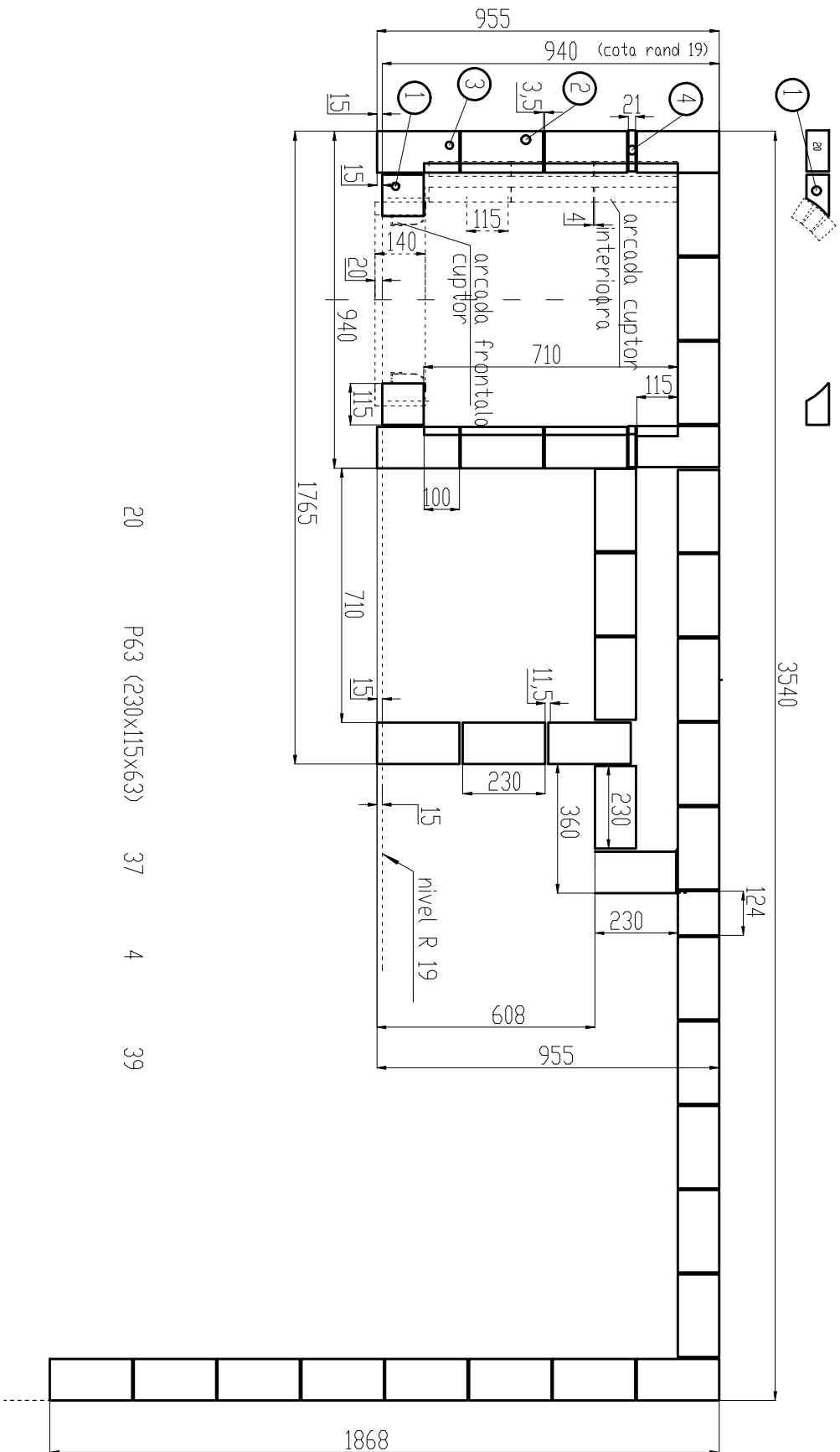

20 P63 (230x115x63) 37 4 39





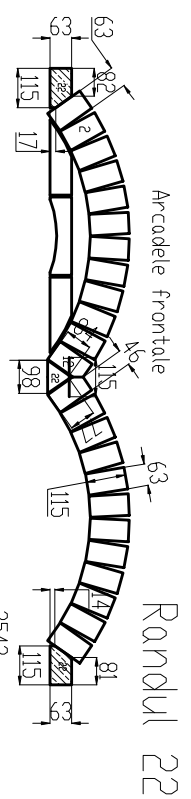

22	P63 (230x115x63)	37	6	40
	Arcade frontale	P63 (230x115x63)	24	24

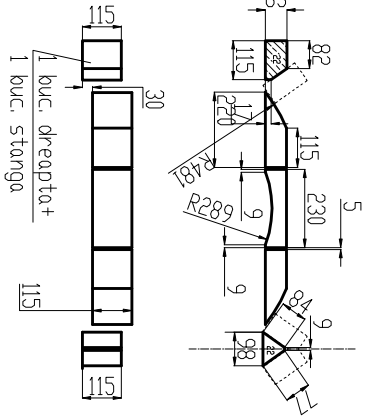
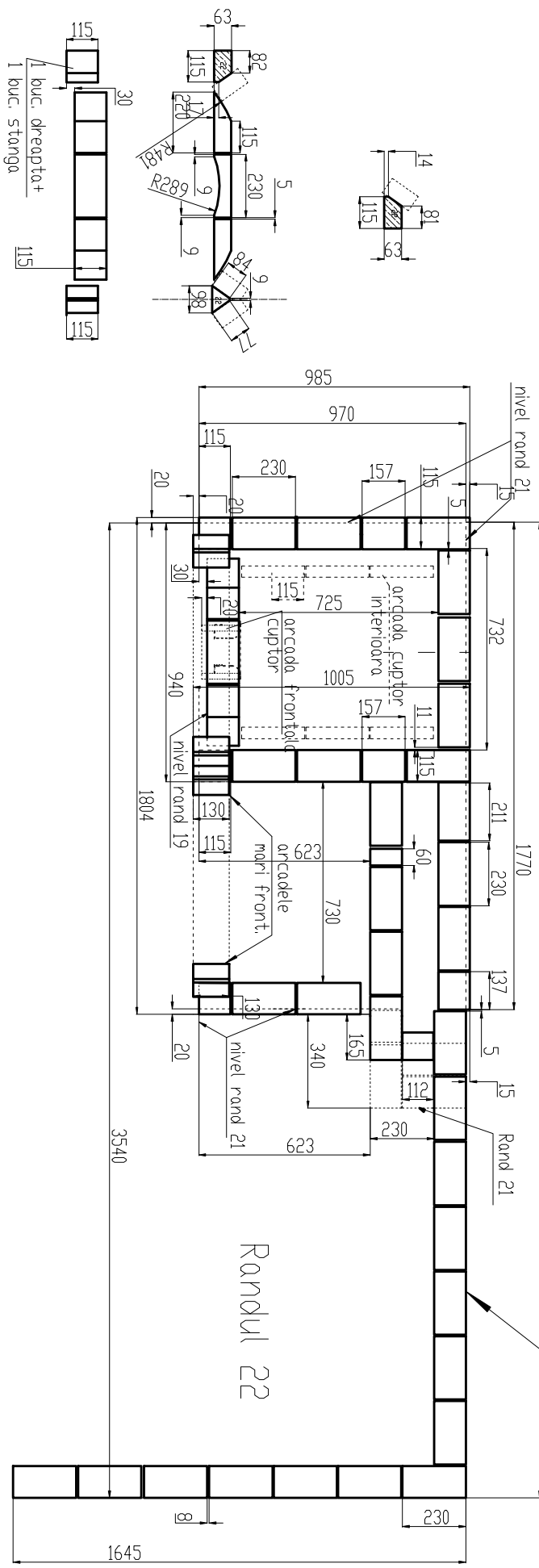

Randul 22

nivel R19,20

Rand 21

Randul 22

Arcadele frontale







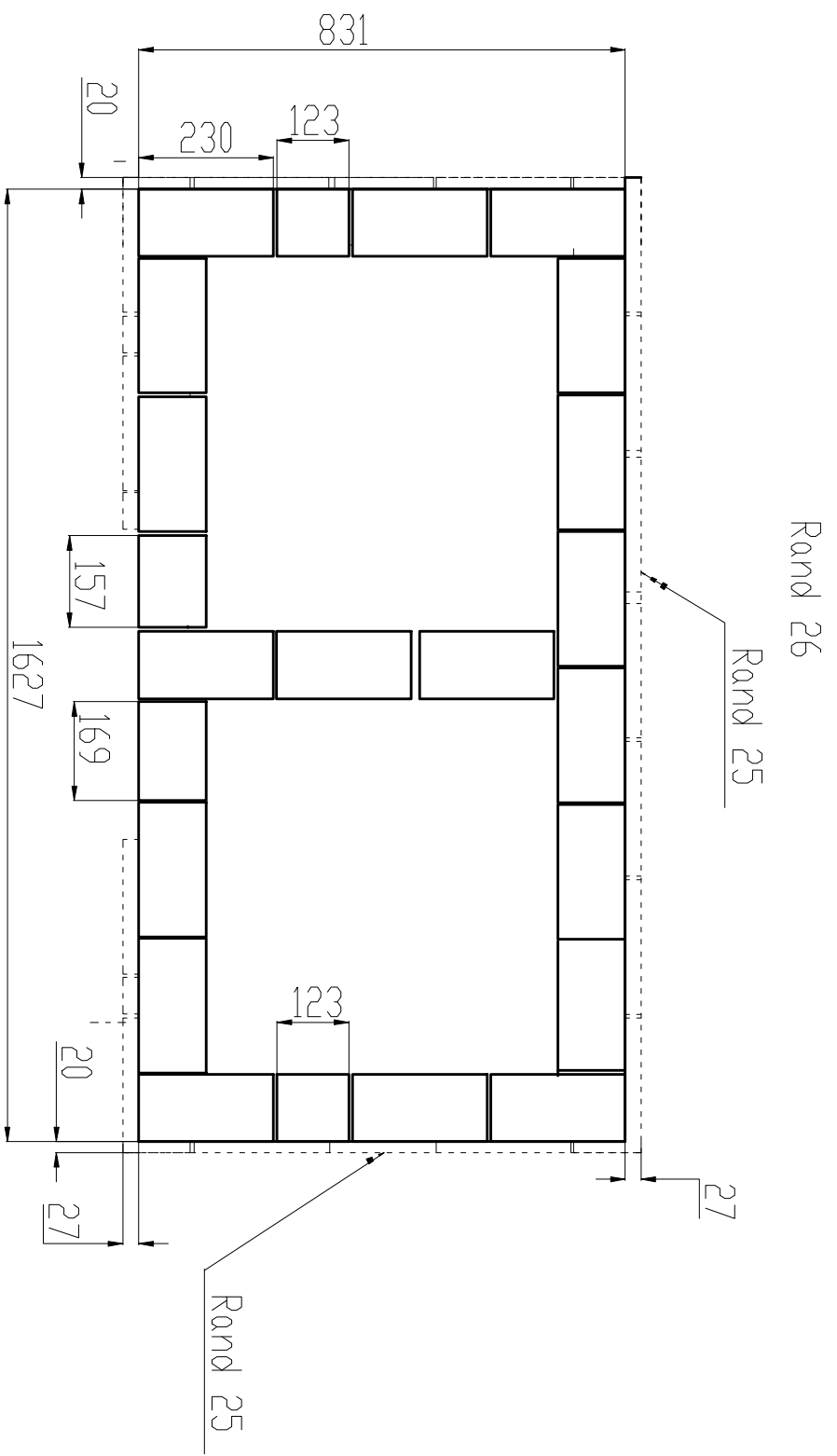

26 P63 (230x115x63) 23 23

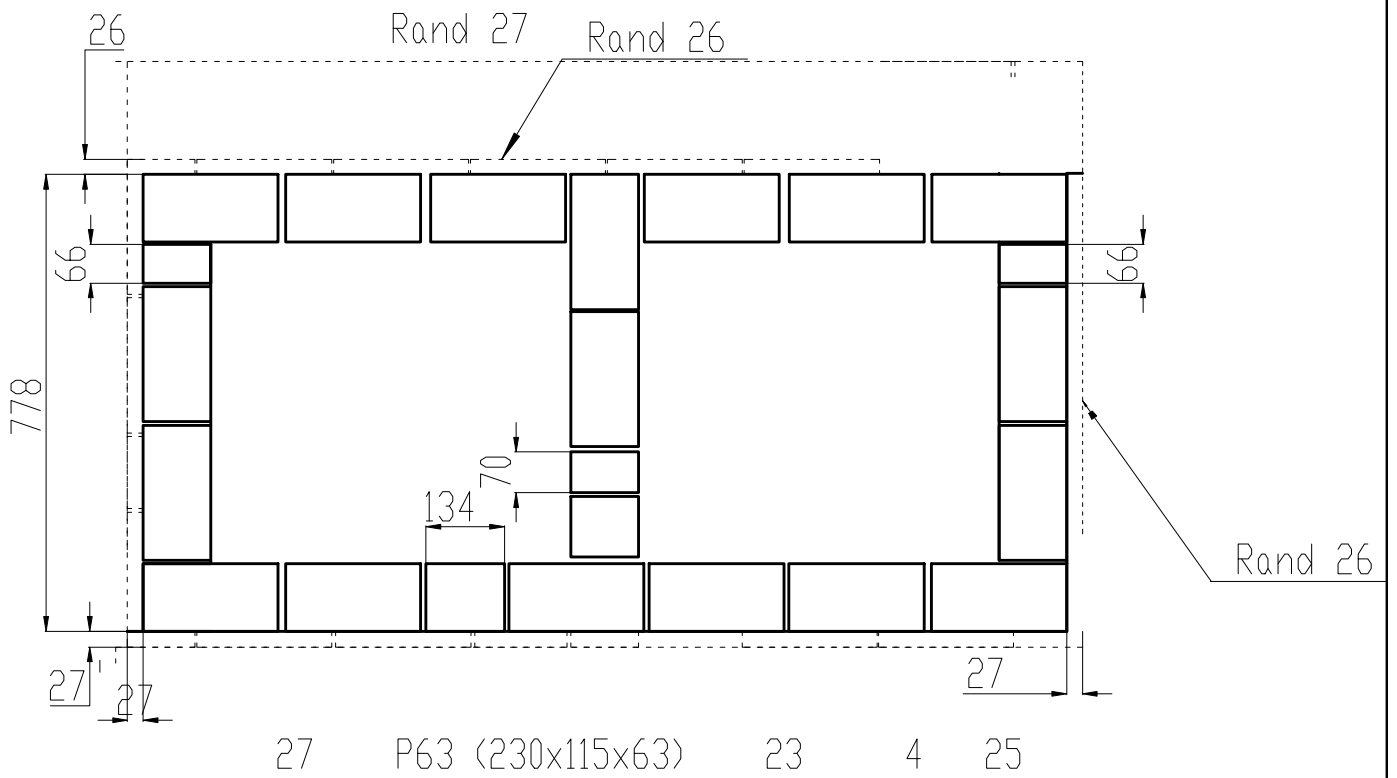
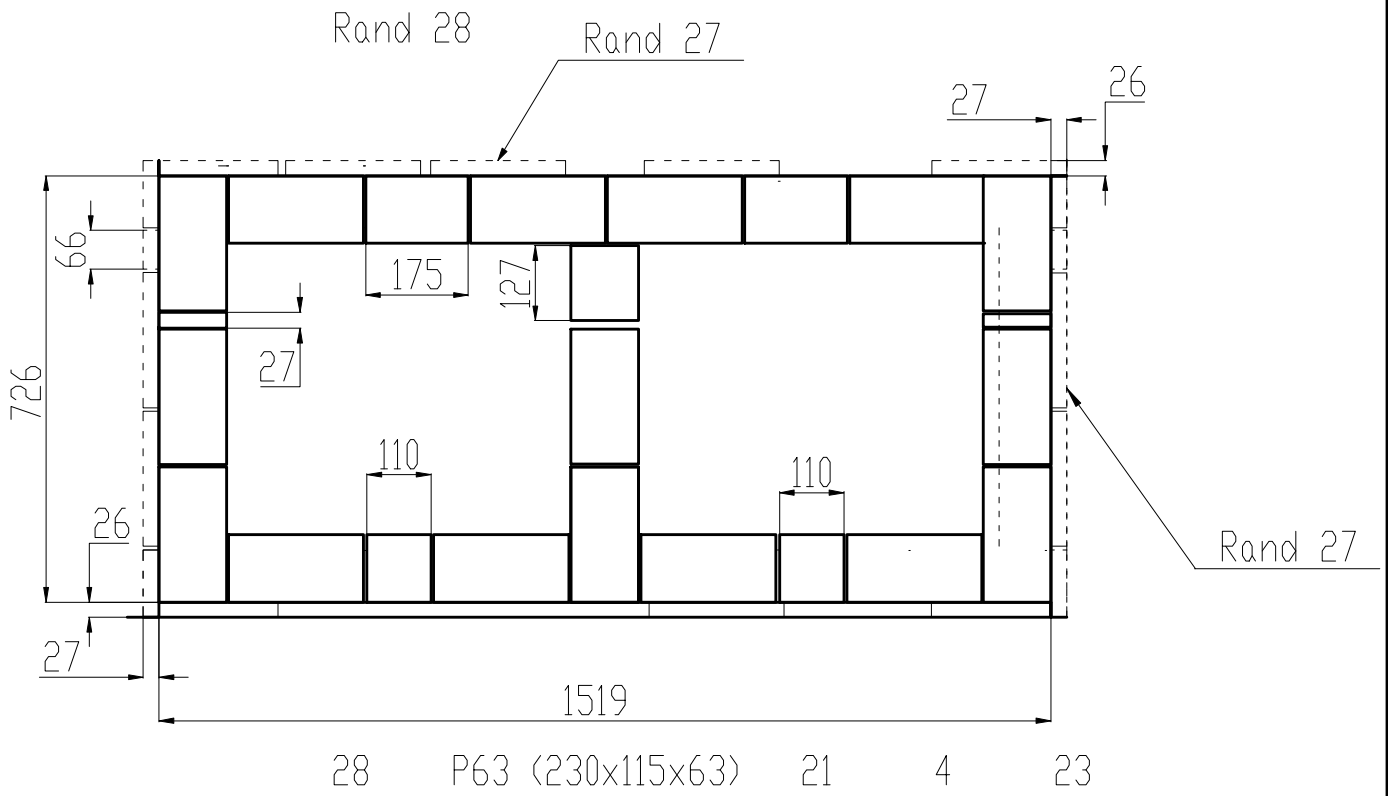

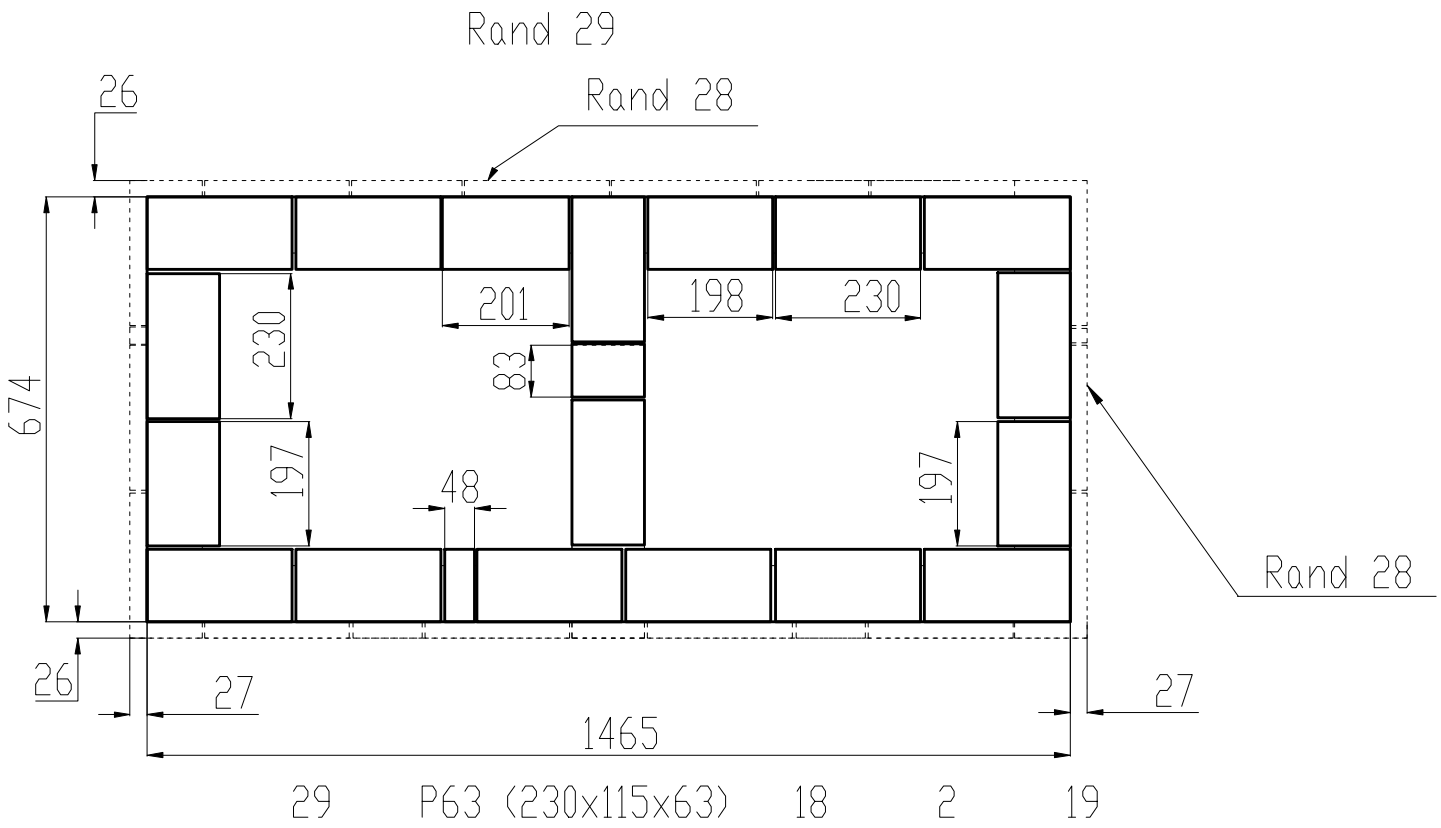
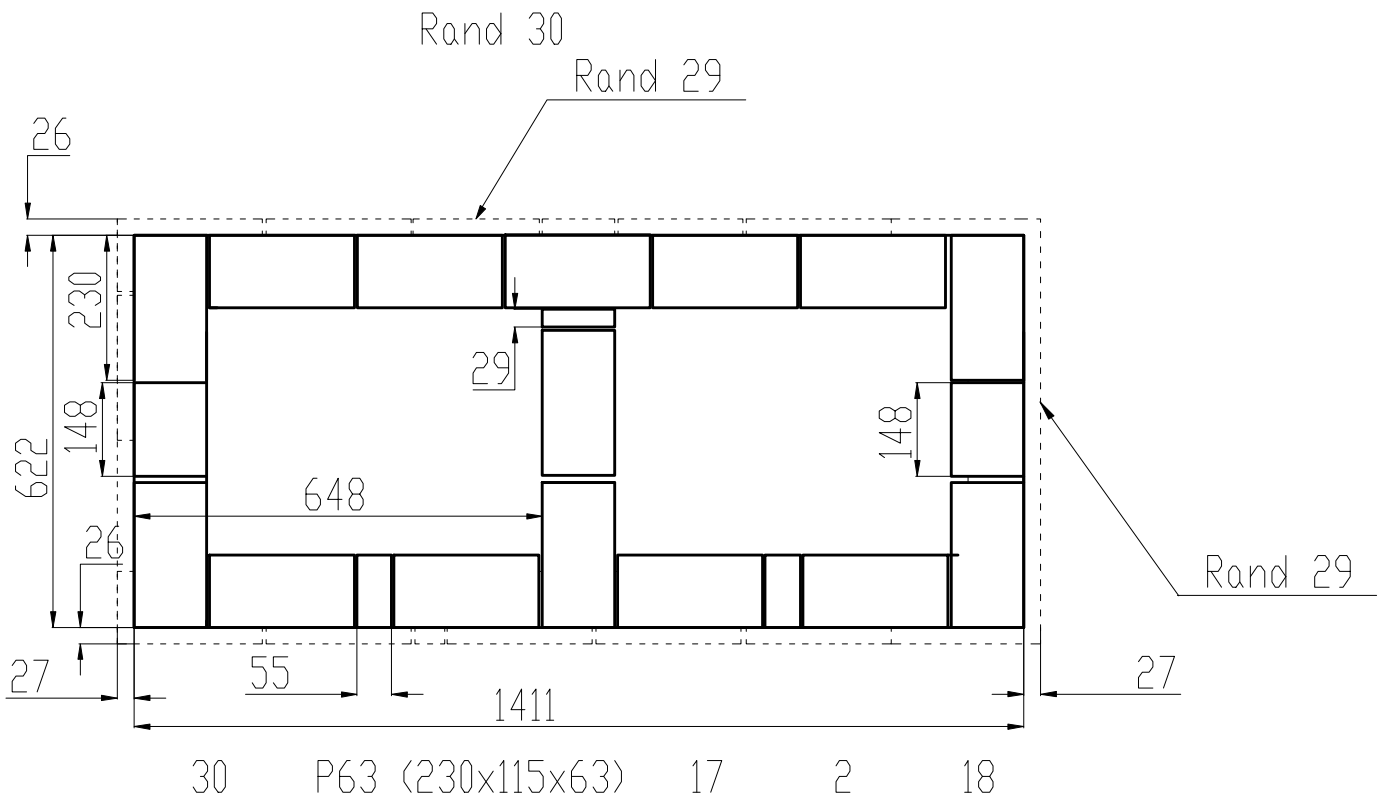

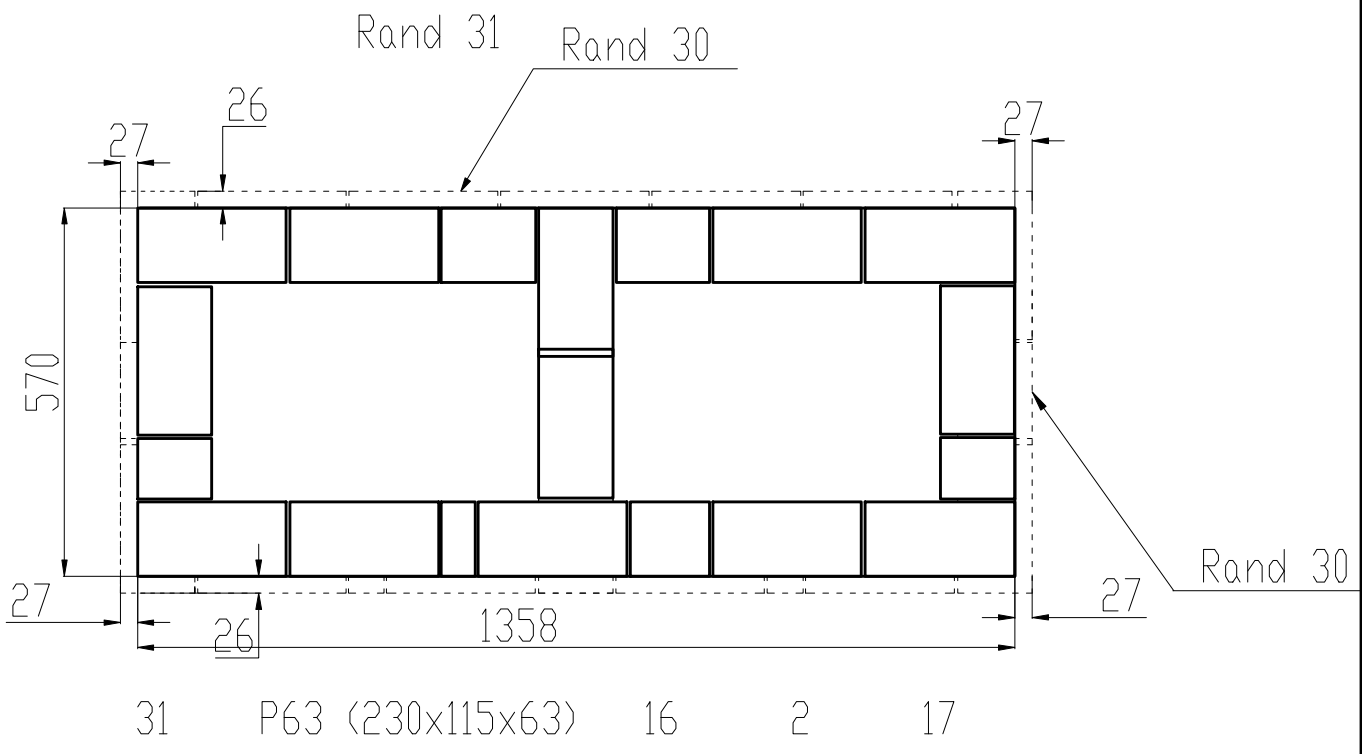
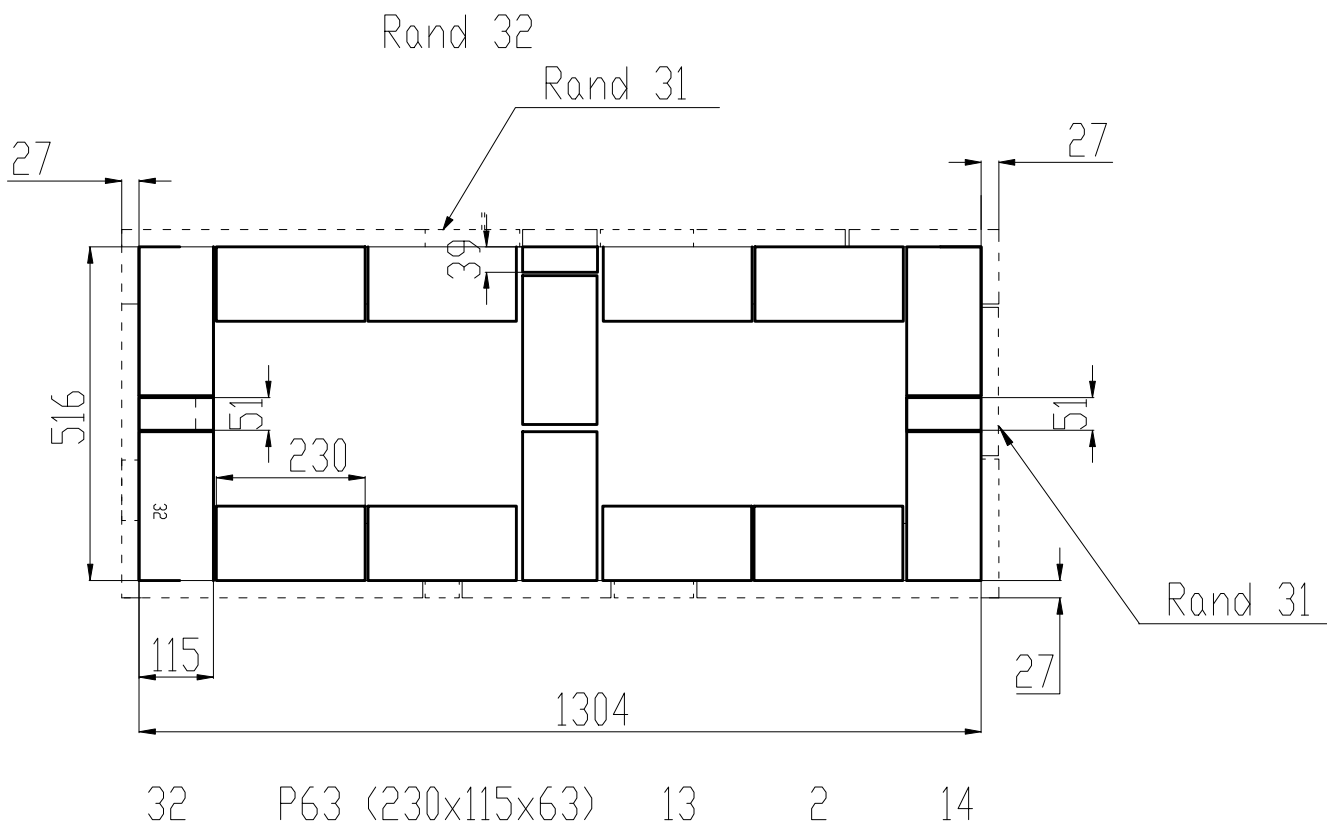



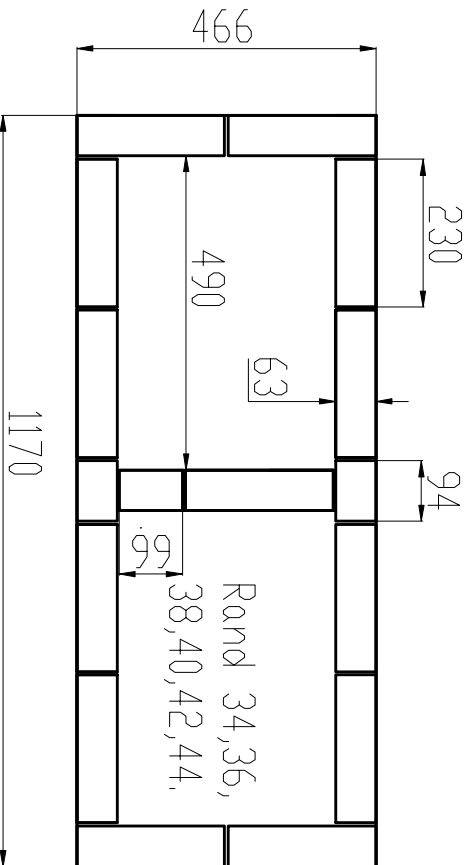

34	P63 (230x115x63)	13	2	14
36	P63 (230x115x63)	13	2	14
38	P63 (230x115x63)	13	2	14
40	P63 (230x115x63)	13	2	14
42	P63 (230x115x63)	13	2	14
44	P63 (230x115x63)	13	2	14

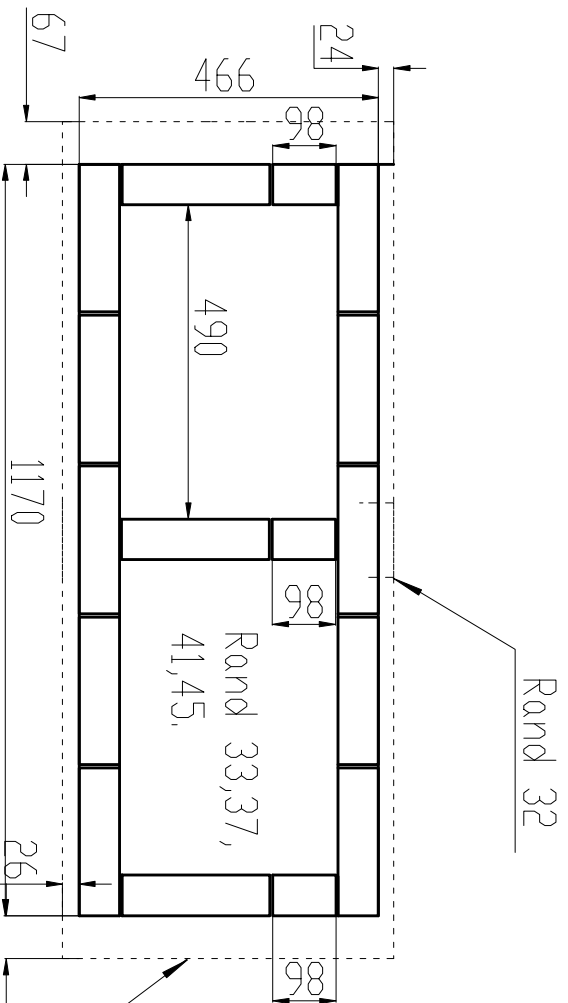

33	P63 (230x115x63)	12	3	13.5
37	P63 (230x115x63)	12	3	13.5
41	P63 (230x115x63)	12	3	13.5
45	P63 (230x115x63)	12	3	13.5
Rand 32				

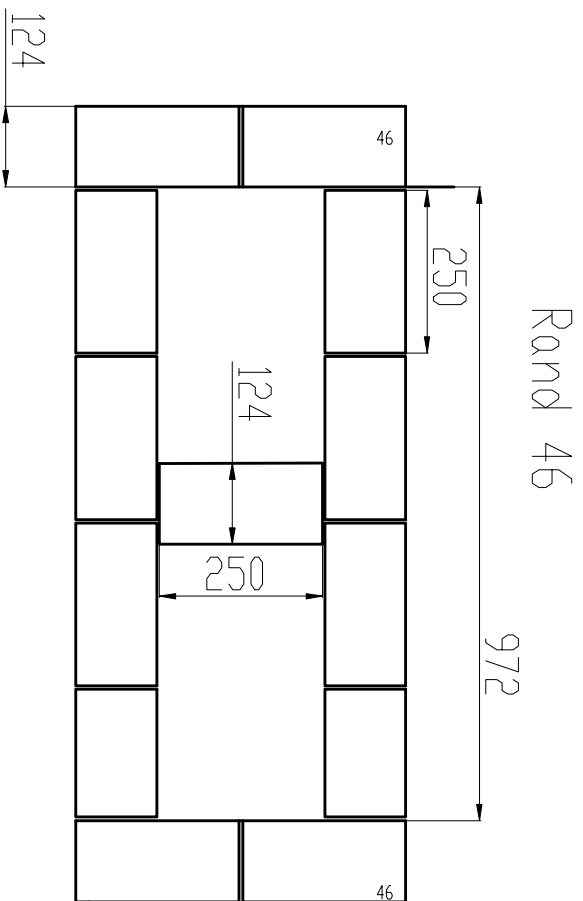

46

2R-28AS (250x124x64) 13

13

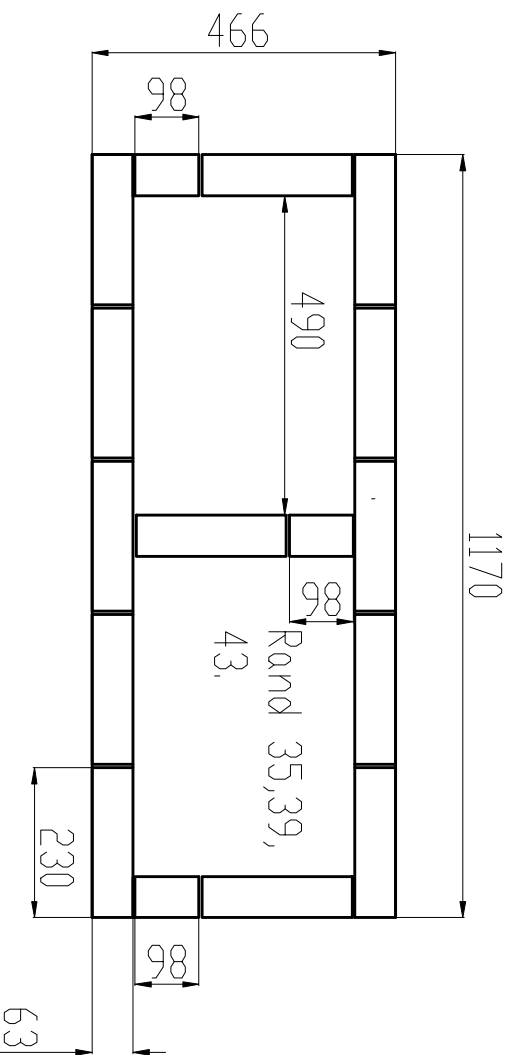

35	P63 (230x115x63)	13	3	14,5
39	P63 (230x115x63)	13	3	14,5
43	P63 (230x115x63)	13	3	14,5

## Lista de caramizi varianta completa

Caramizi P63 (230x115x63)

Nr. rand	Nr. caramizi
1	171
2	77
3	53
4	53
5	54
6	53
7	53
8	96
9	55
10	54
11	67
12	74
13	69
14	44
15	47
16	56
17	43
18	40
19	44
20	39
21	64
22	40
23	39
24	36
25	23
26	23
27	25
28	23
29	19
30	18
31	17
32	14
33	13,5
34	14
35	14,5
36	14
37	13,5
38	14
39	14,5
40	14
41	13,5
42	14
43	14,5
44	14
45	13,5

Total 1765buc.

Caramizi R-28 AS

Nr. rand	Nr. caramizi
2	25
13	15
16	7
20	33

Total 80

Caramizi 2R-28 AS

Nr. rand	Nr. caramizi
46	13

Total 12 buc.

Caramizi R32-28 AS

Nr. rand	Nr. caramizi
17	26
19	4
Total	30 buc.