

CAPTUSEALA SOBETI LA FOCAR

A-A

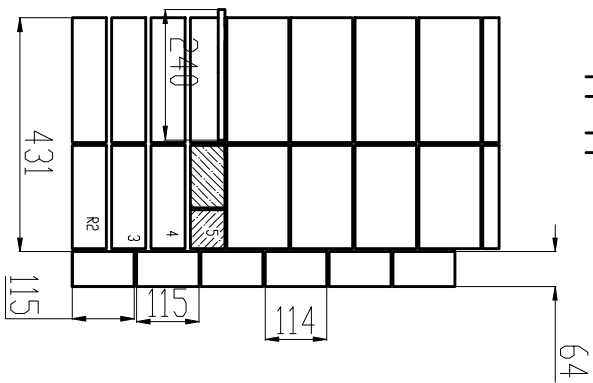

B-B

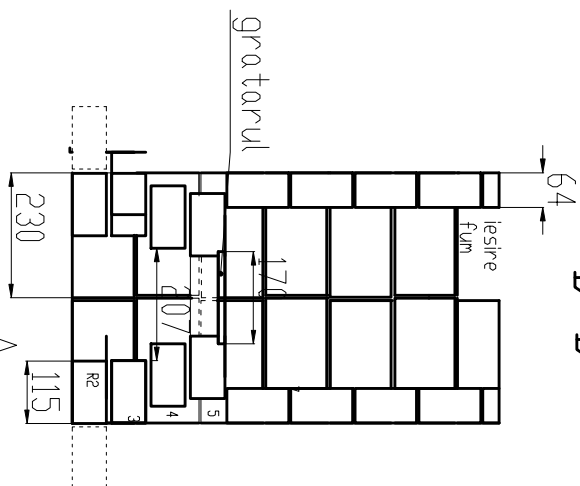

Vedere frontala soba

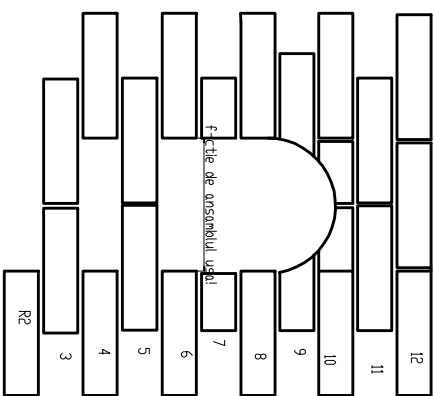

Nota: Pana la randul 4 se executa din rosie iar mai sus samota.

Vedere de sus
fara peretii laterali

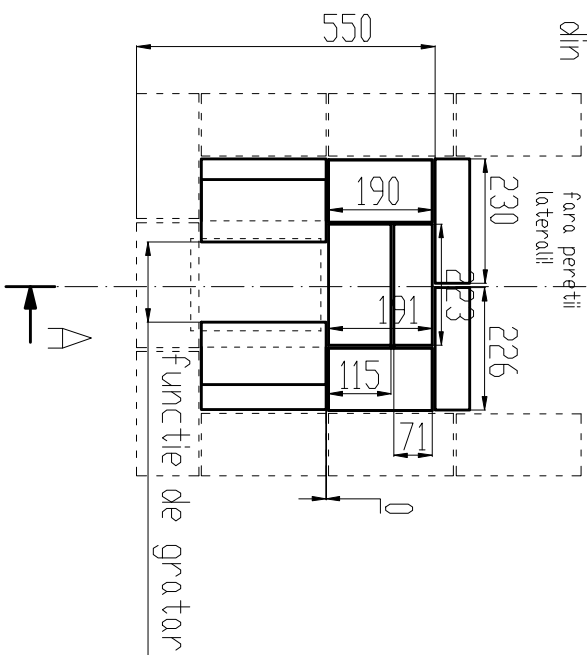

RAND 1

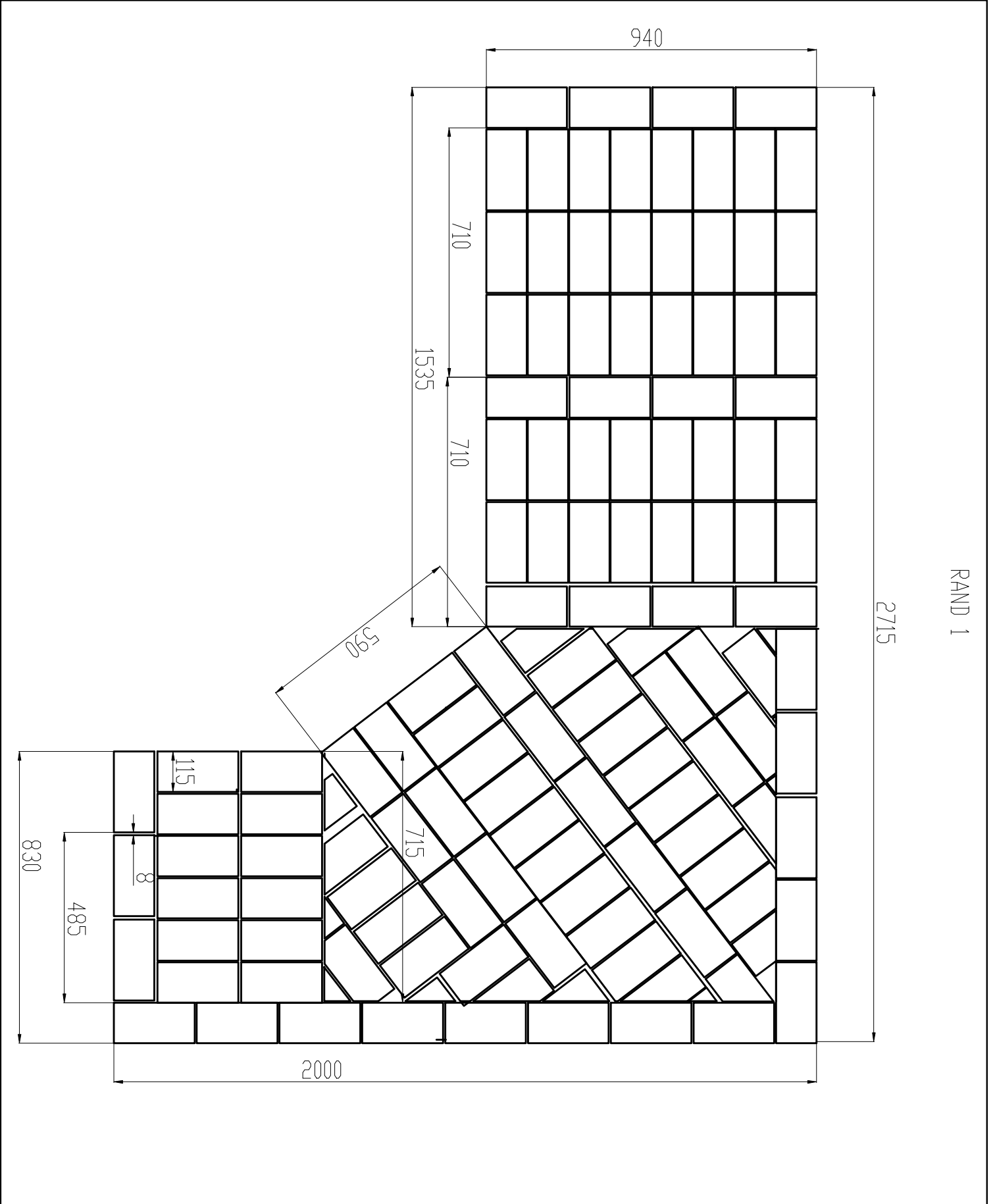

Randul 2

B-B

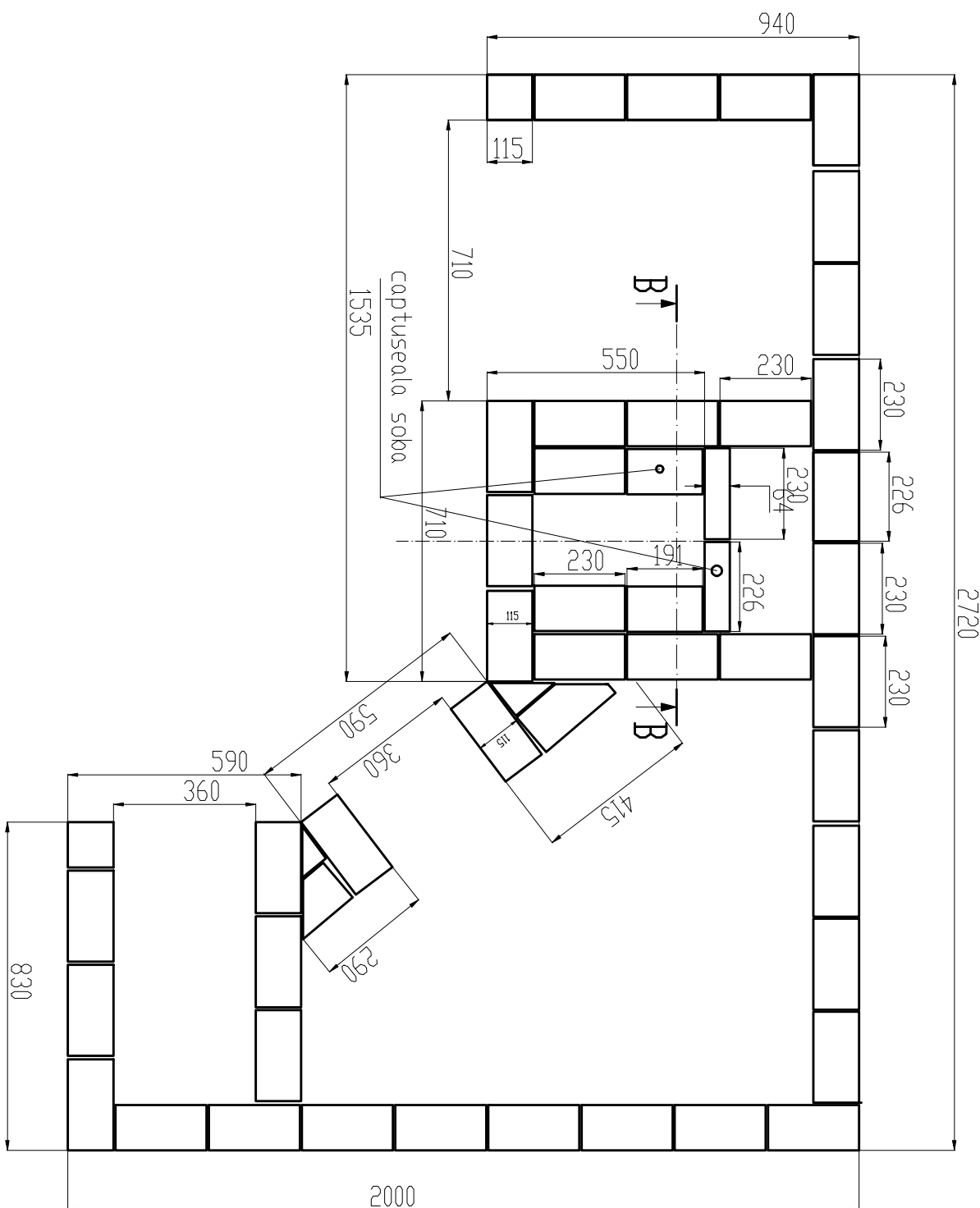
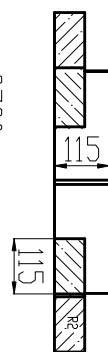

Randul 4 si 6

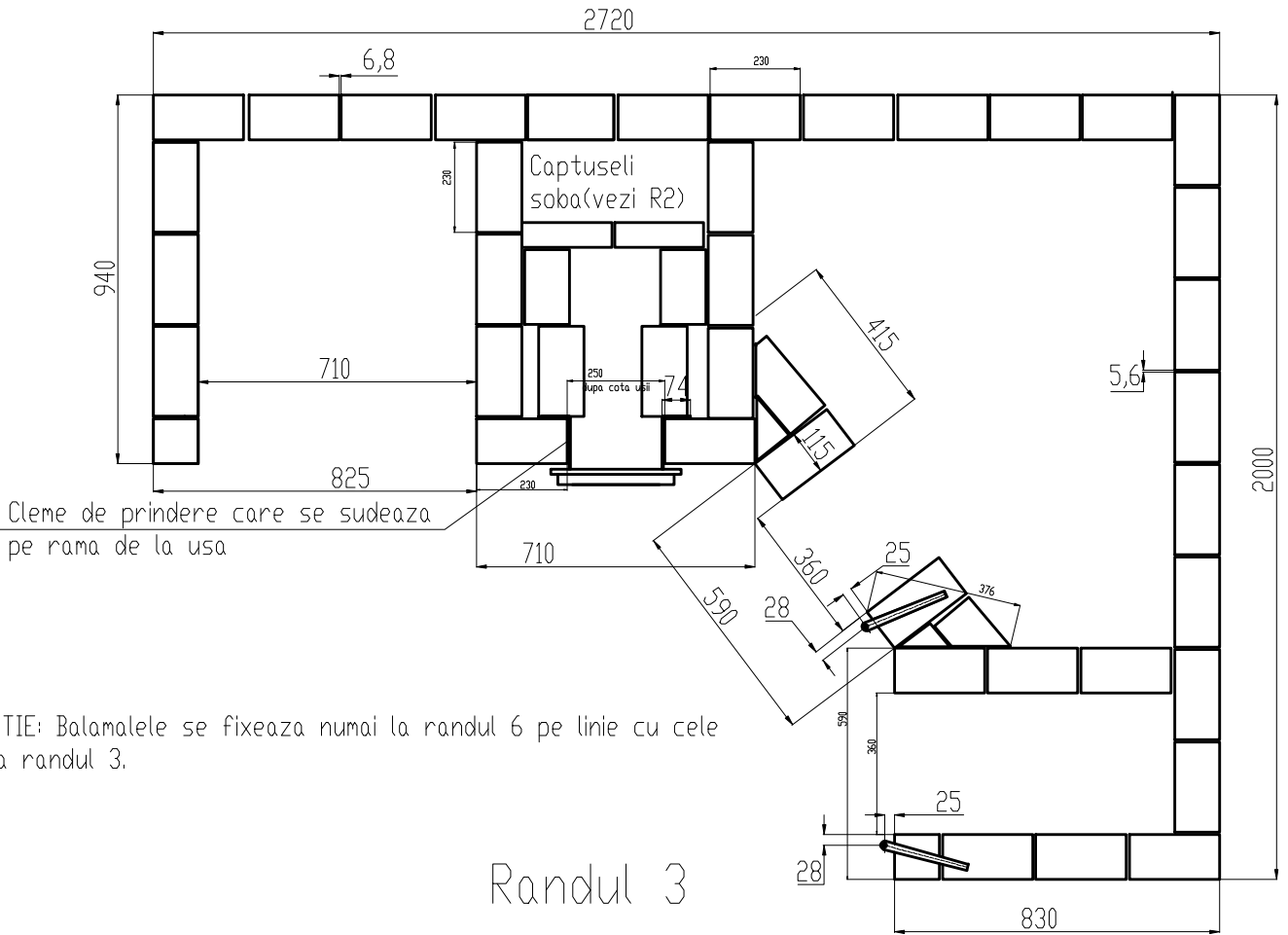

ATENTIE: Balamalele se fixeaza numai la randul 6 pe linie cu cele de la randul 3.

Randul 3

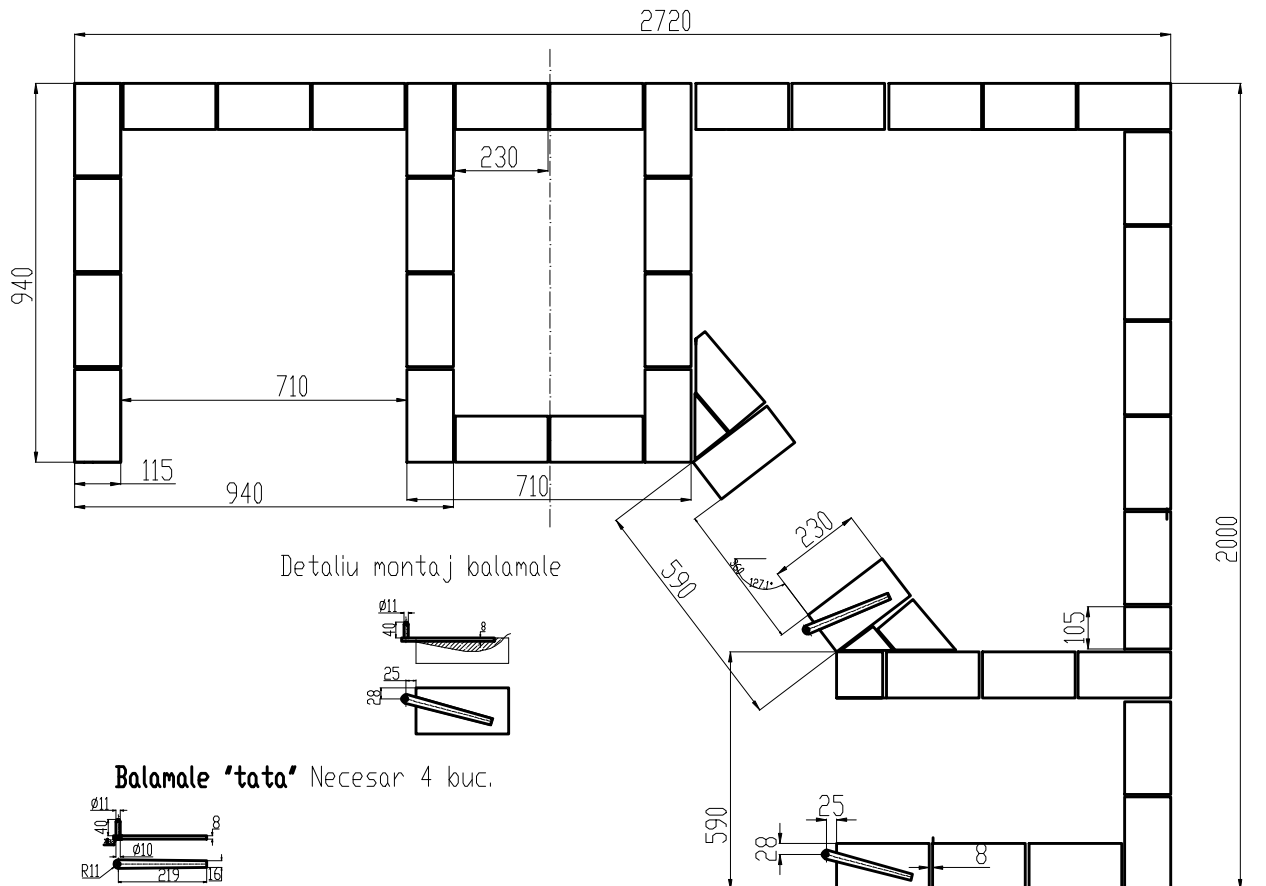

Randul 7

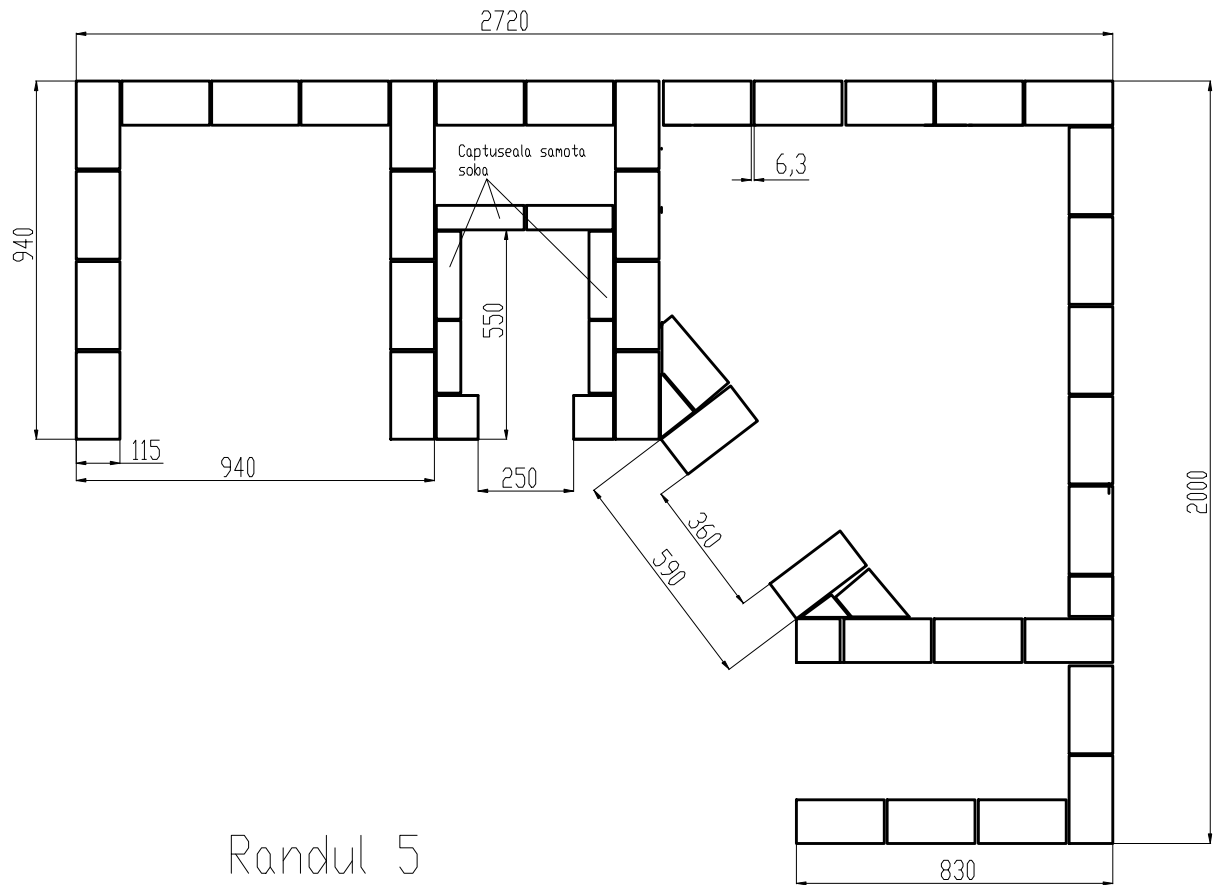

Randul 5

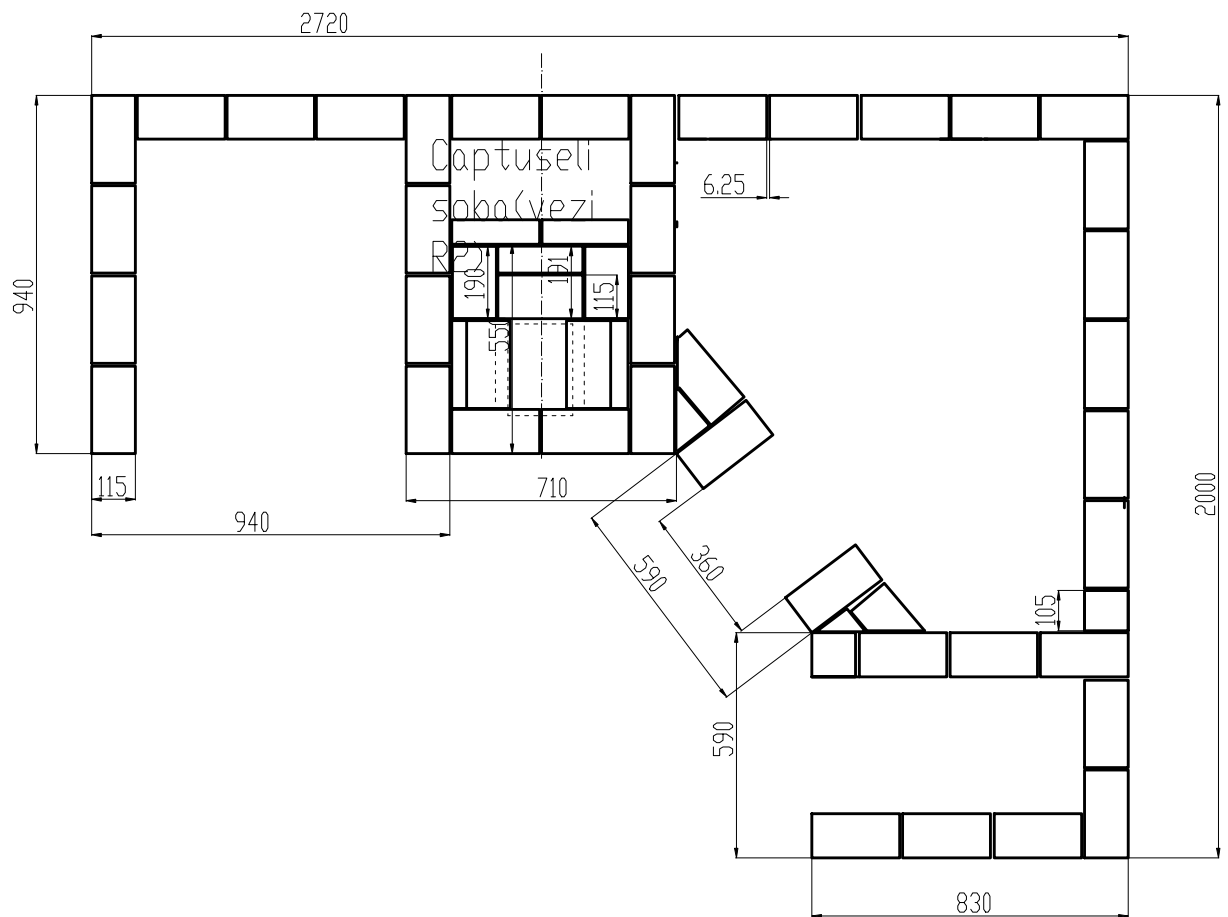

Construcția arcadelor la R8

RANDUL 8

Vedere din A

Arcaada,
Vedere din B

Arcaada,
Vedere din C

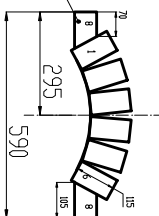
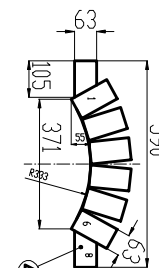
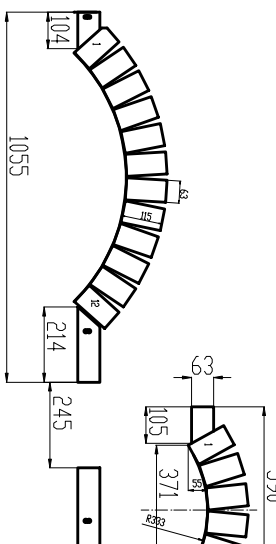
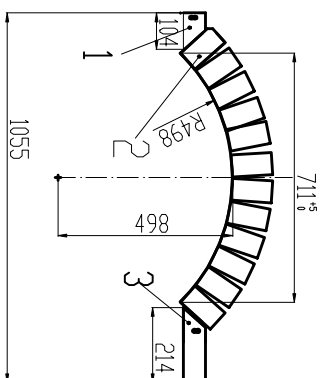

8

Caromizi tăiați R8

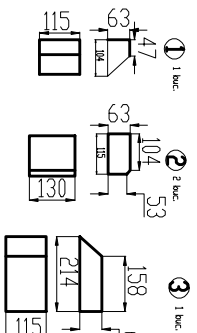

4

Se execută 4 buc.
24-ta-2 sf-găle-1
buc. se taie la lung
cervata.

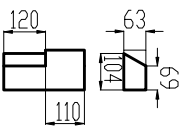

A

B

C

Linia
arcadelor II

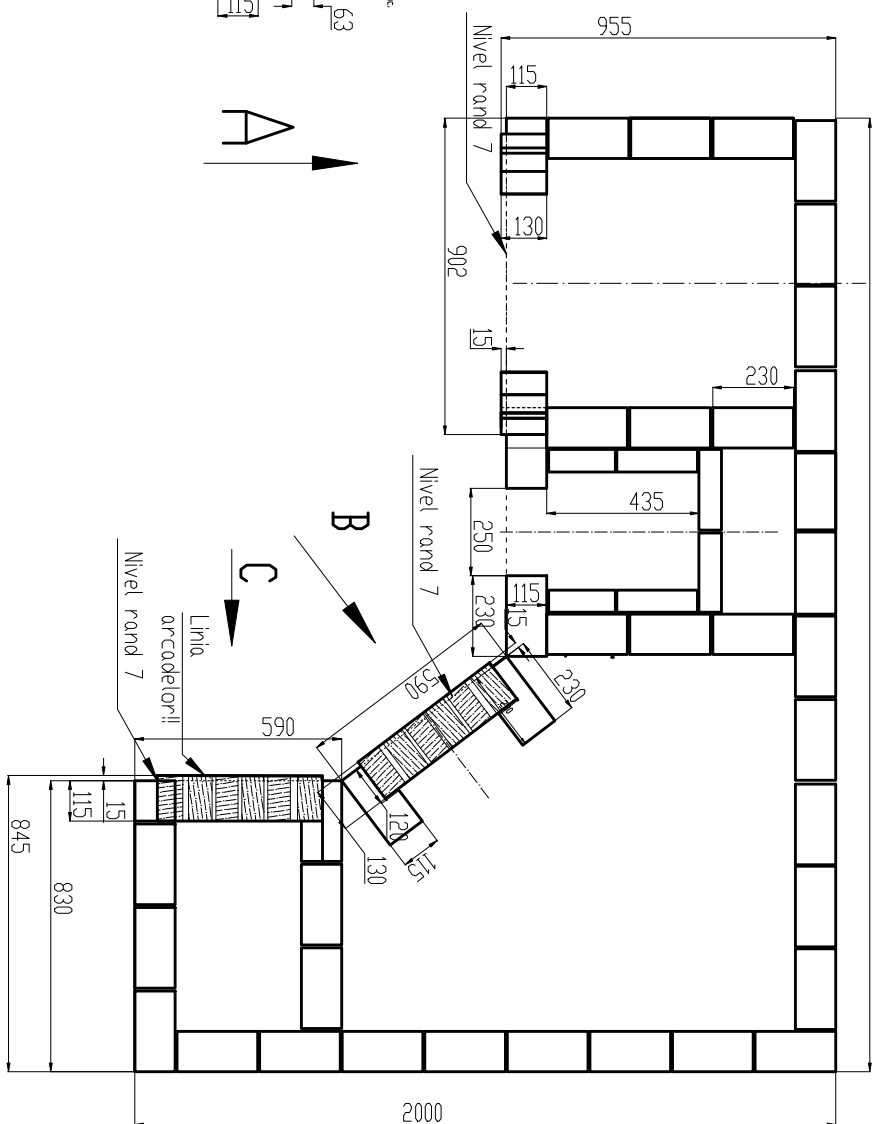

Caramizile prelucrate la R9

RANDUL 9

Vedere din B si C

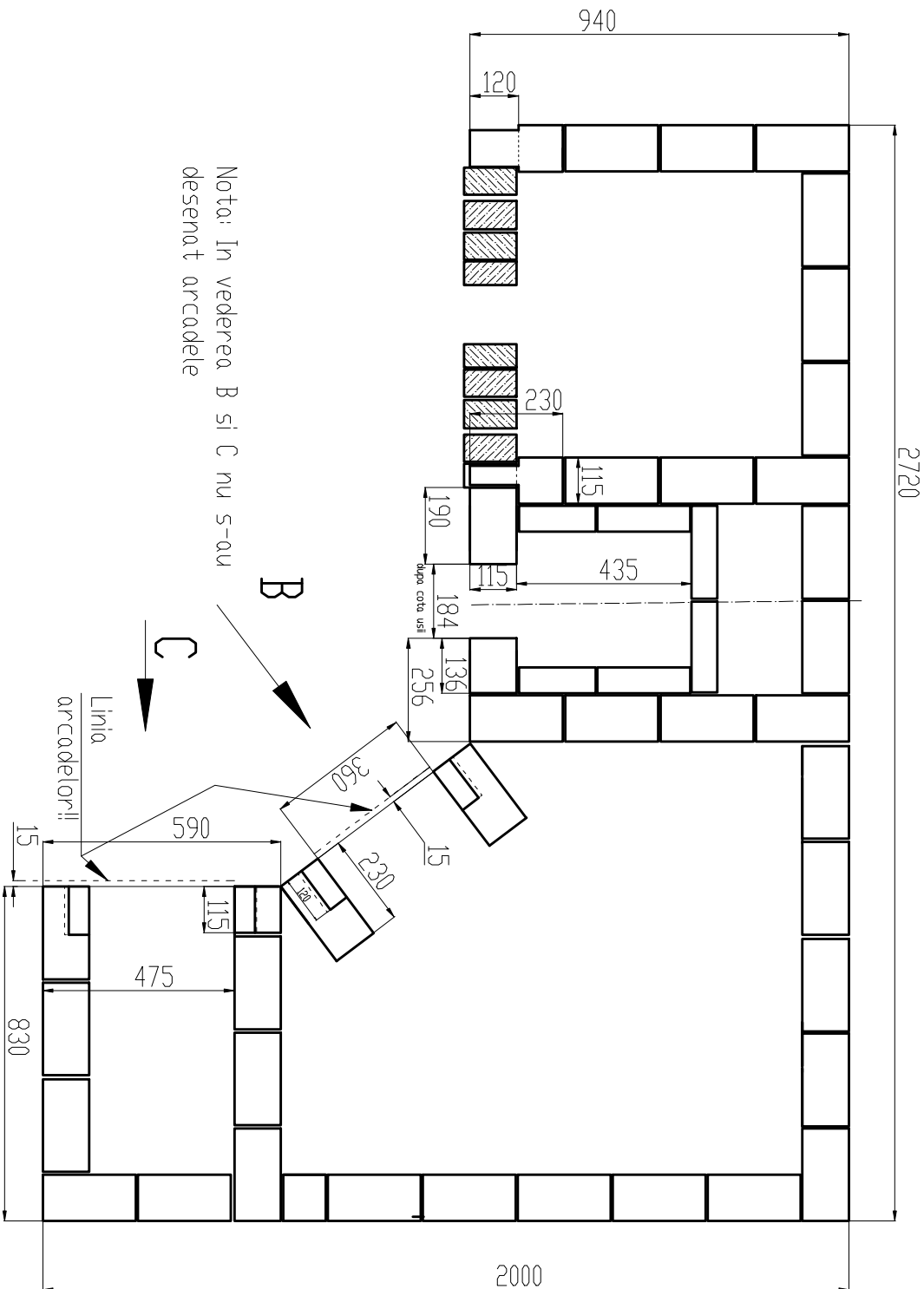
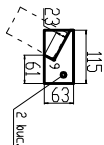
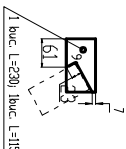
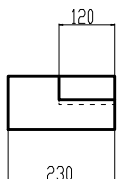
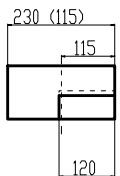
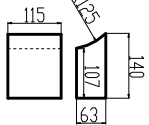
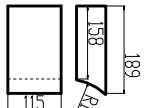
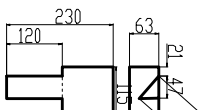
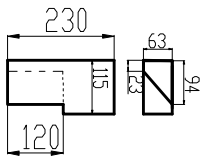

Nota: In vederea B si C nu s-au desenat arcadele

B

C

Linia
arcadelor ii

Randul 10 (fara arcade)

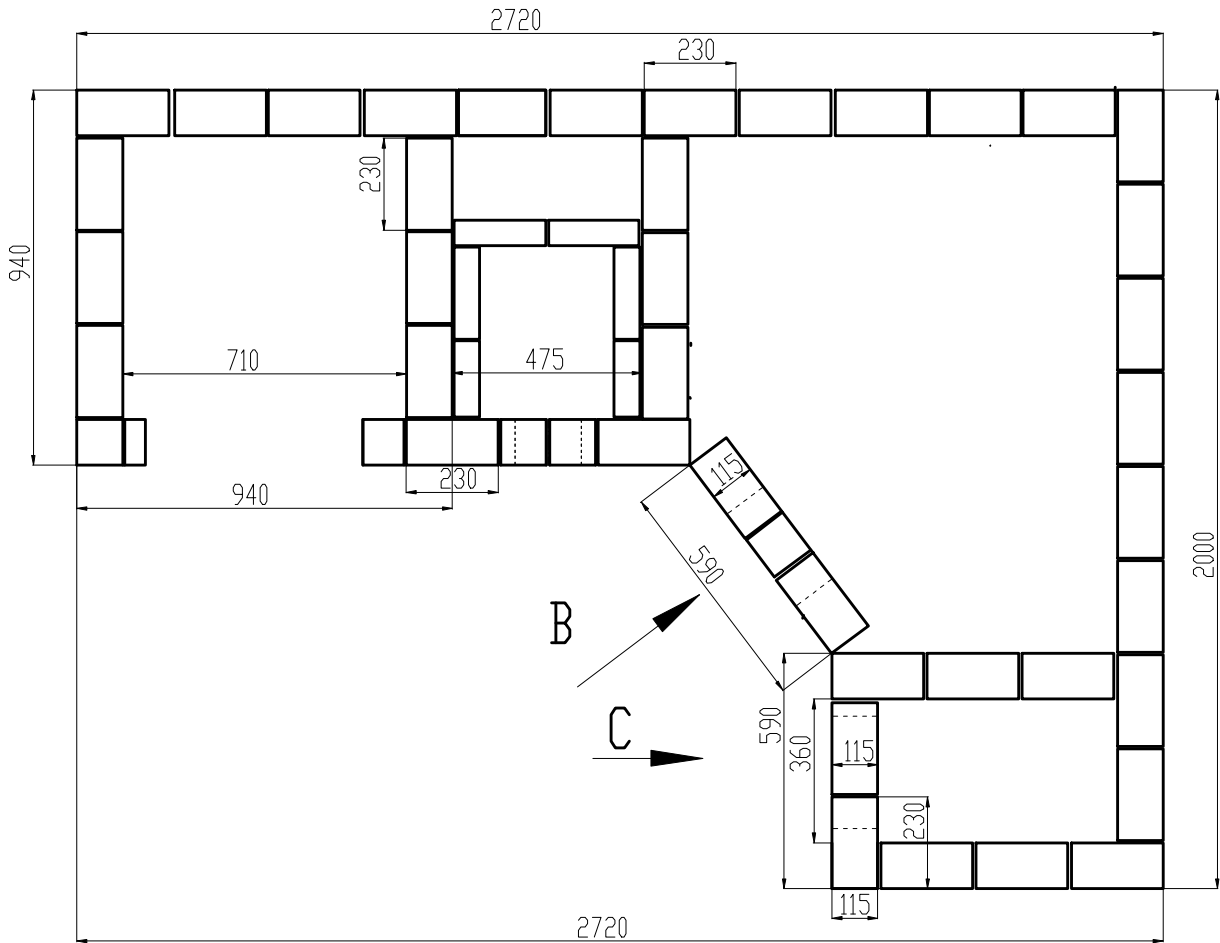
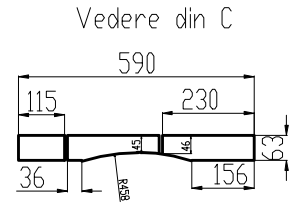
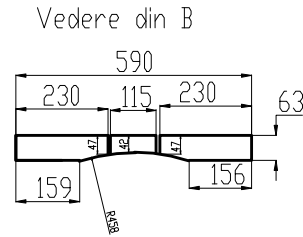
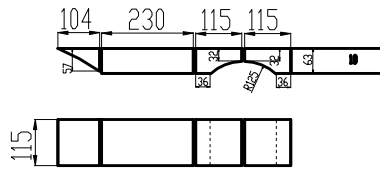
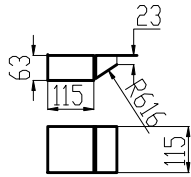

Randul 11

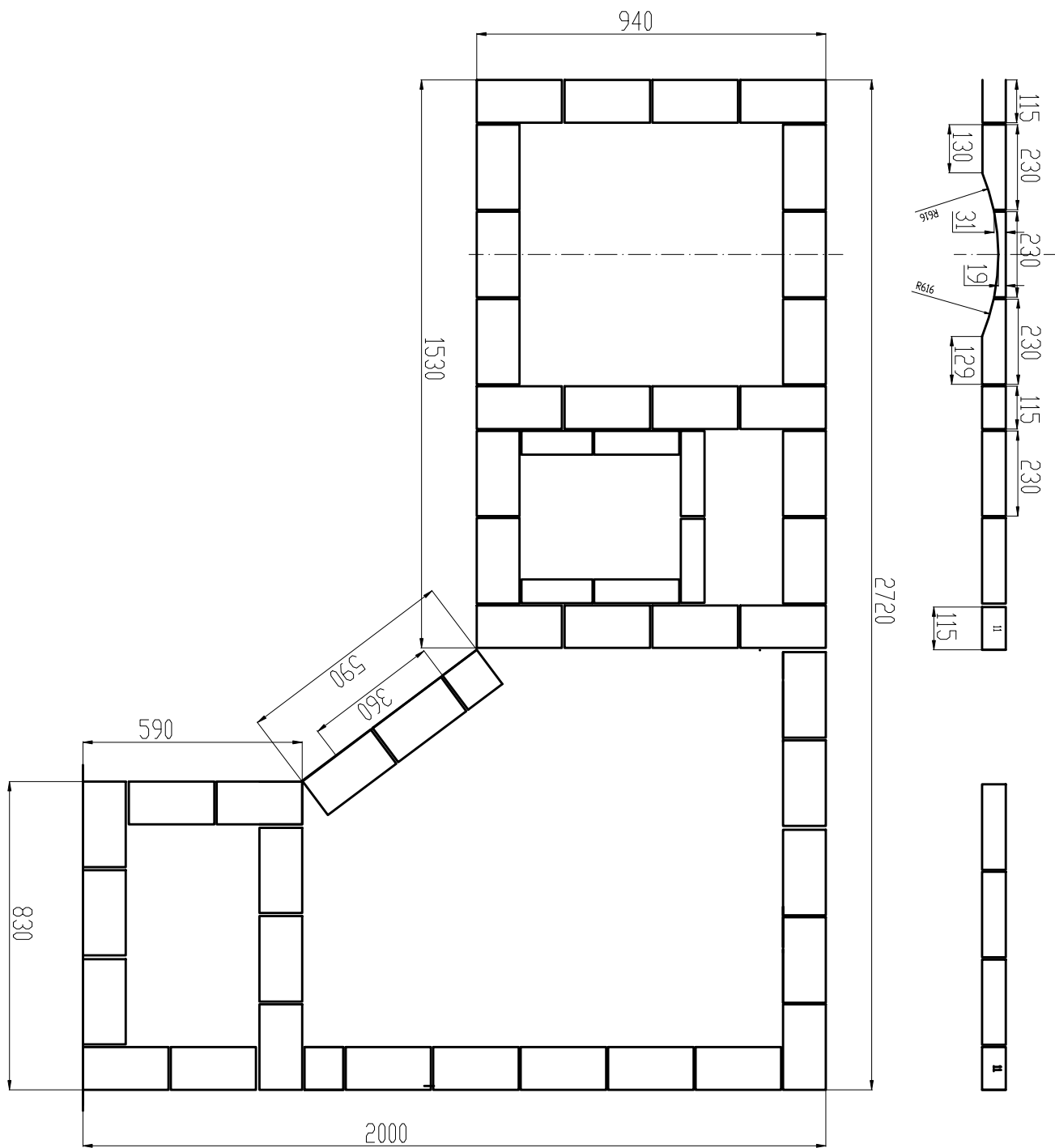

Randul 12

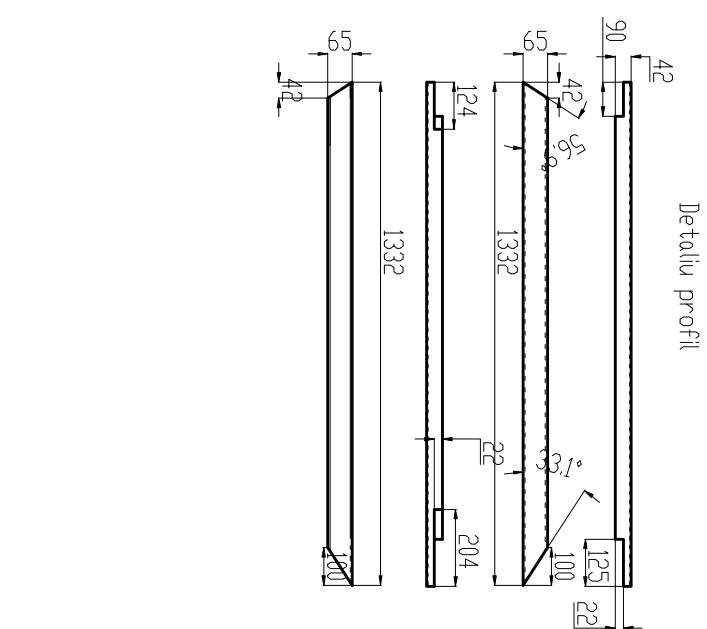
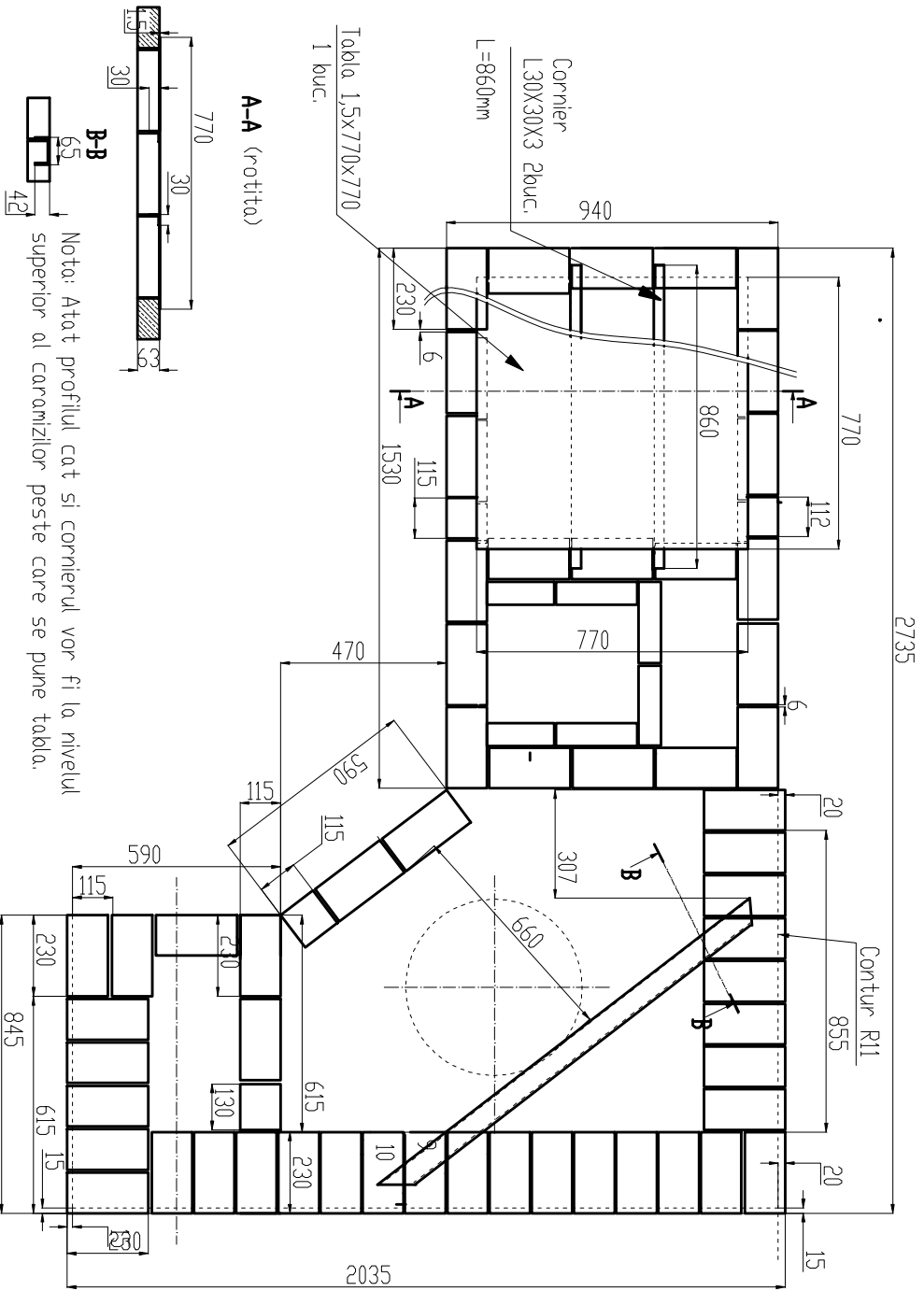

A-A (profița)
B-B
 Nota: Atat profilul cat si cornierul vor fi la nivelul superior al caramizilor peste care se pune tabla.

Randul 13

Atentiei gaura sa nu ajunga la intaritura U651

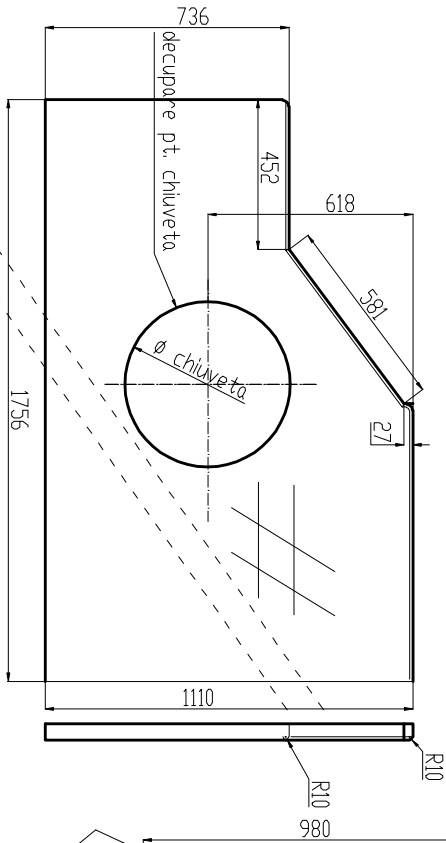

Nota: Placa se traseaza dupa executarea rindului 13 lasand o margine corespunzatoare fata de rindurile inferioare.

NOTA: Caranizile din zona 730x613 sunt din samota (R 28 AS - 230x114x64)
Pe randul 12 se monteaza placiile de marmura respectiv pila.

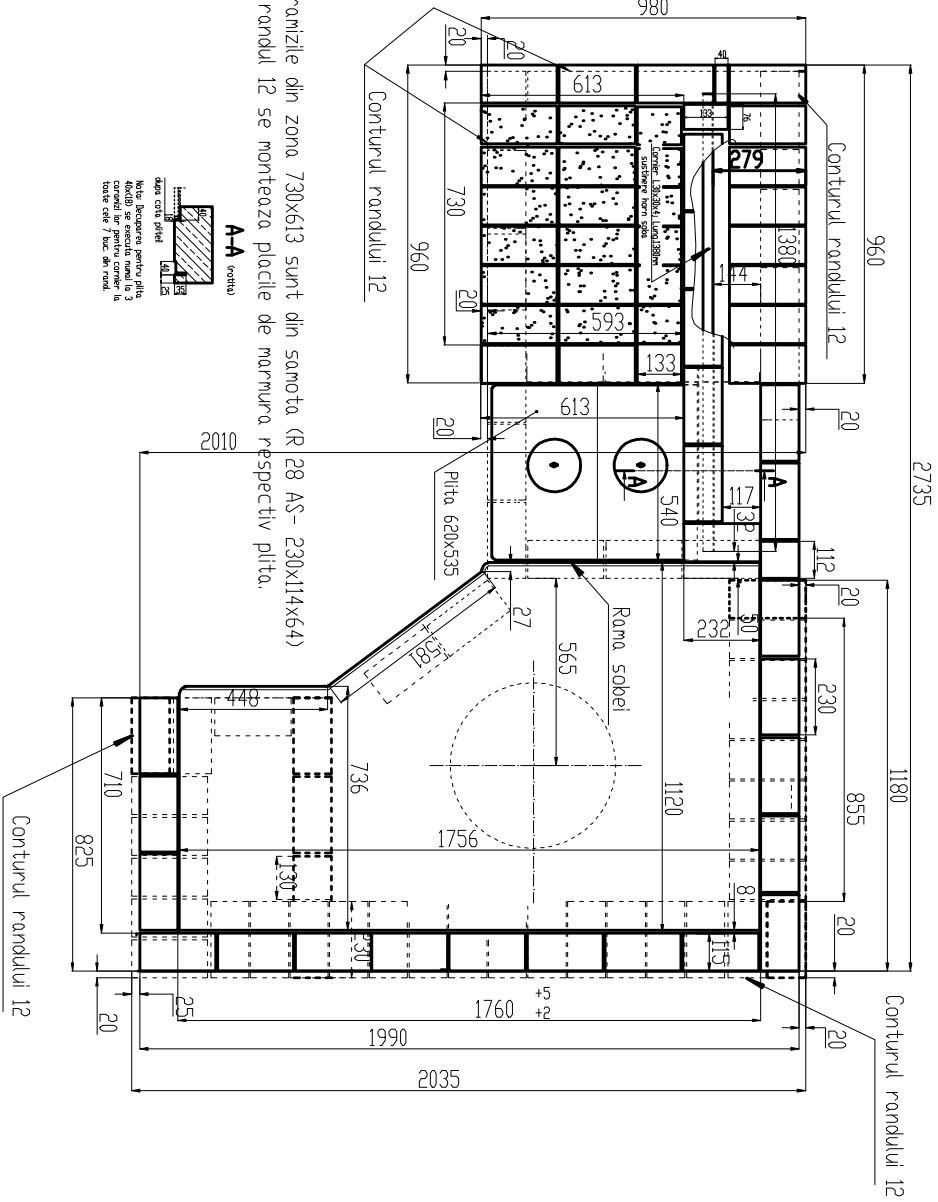
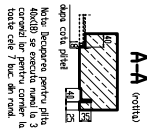

Randul 14

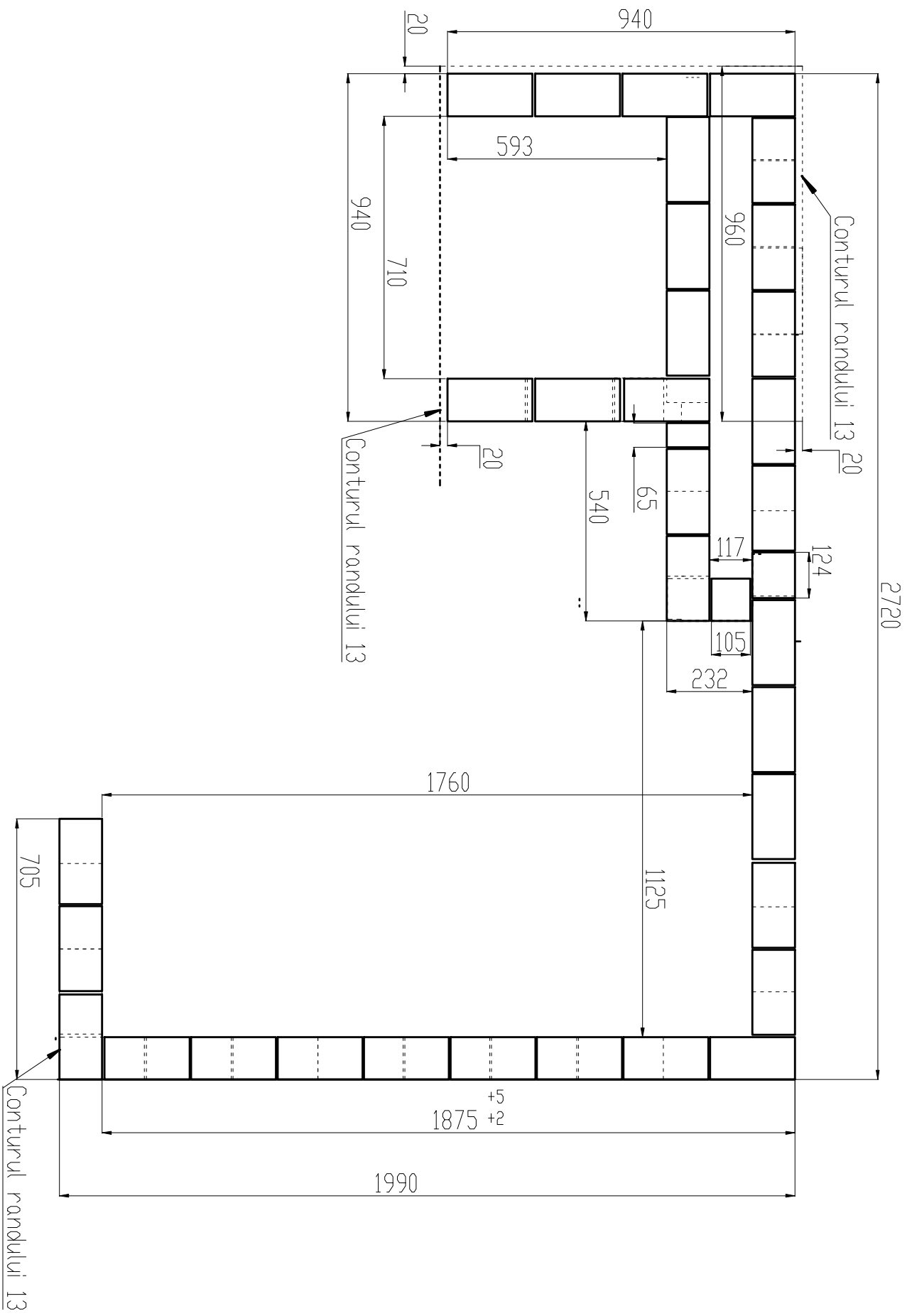

Randul 16

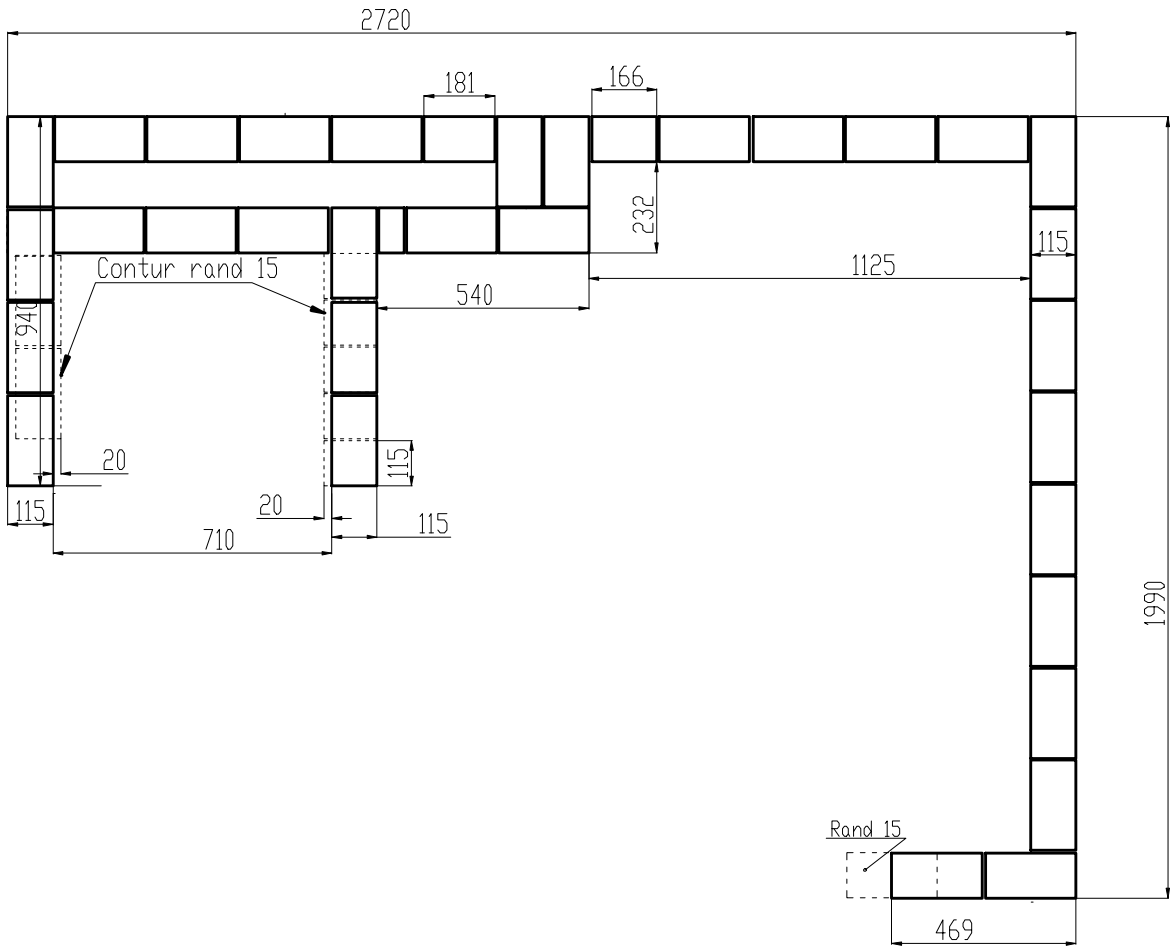

Randul 15

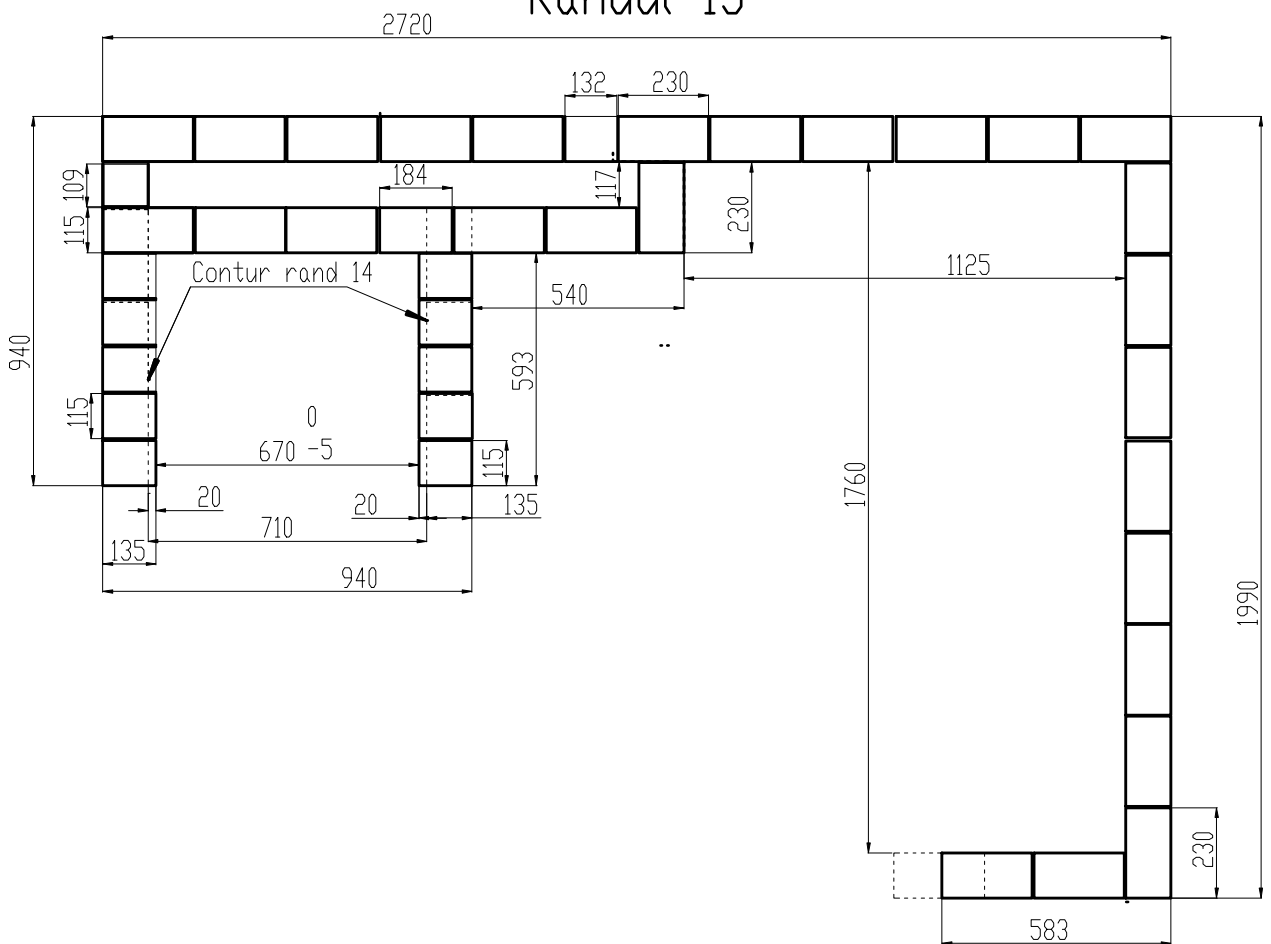

Randul 18

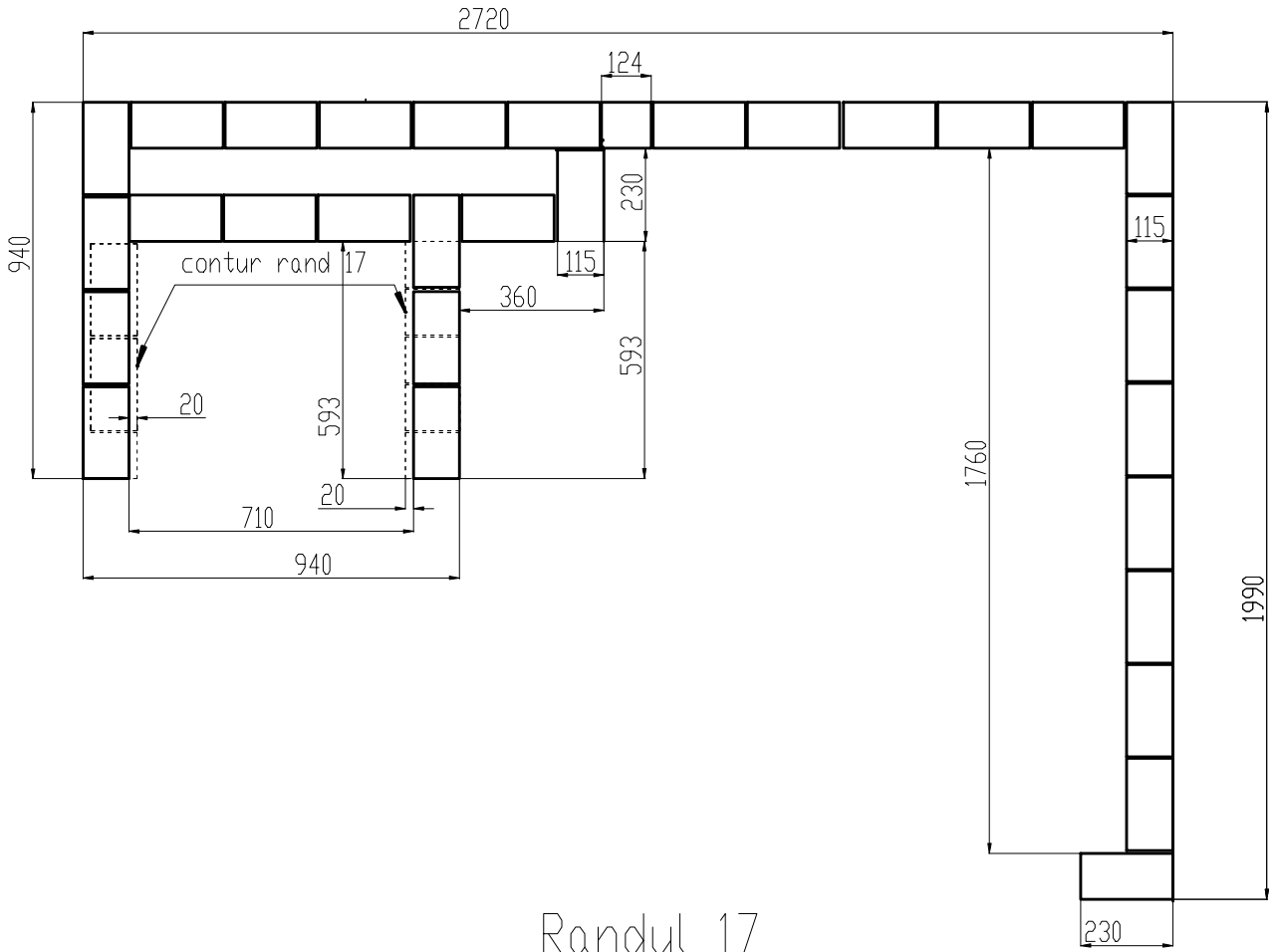

Randul 17

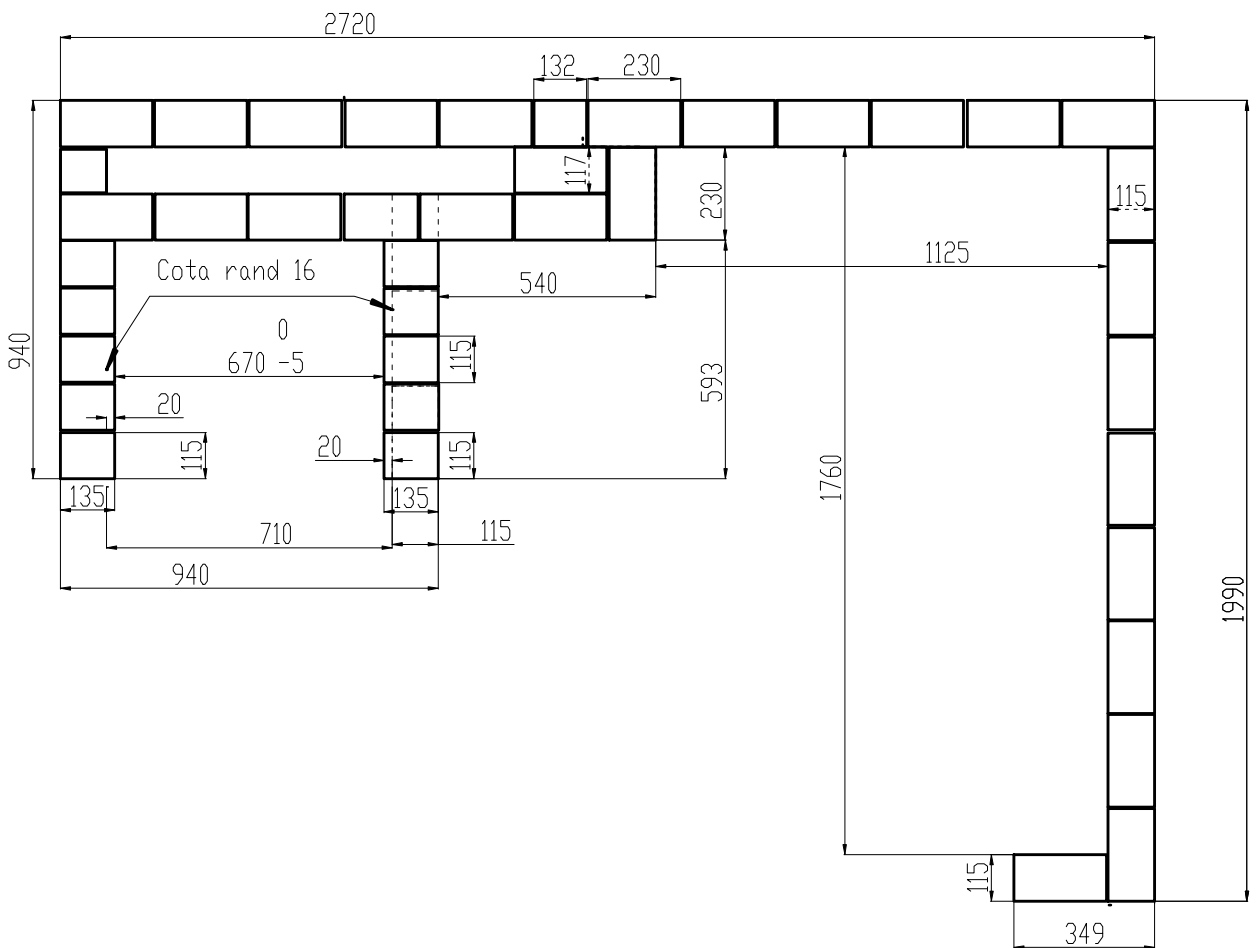

Randul 20

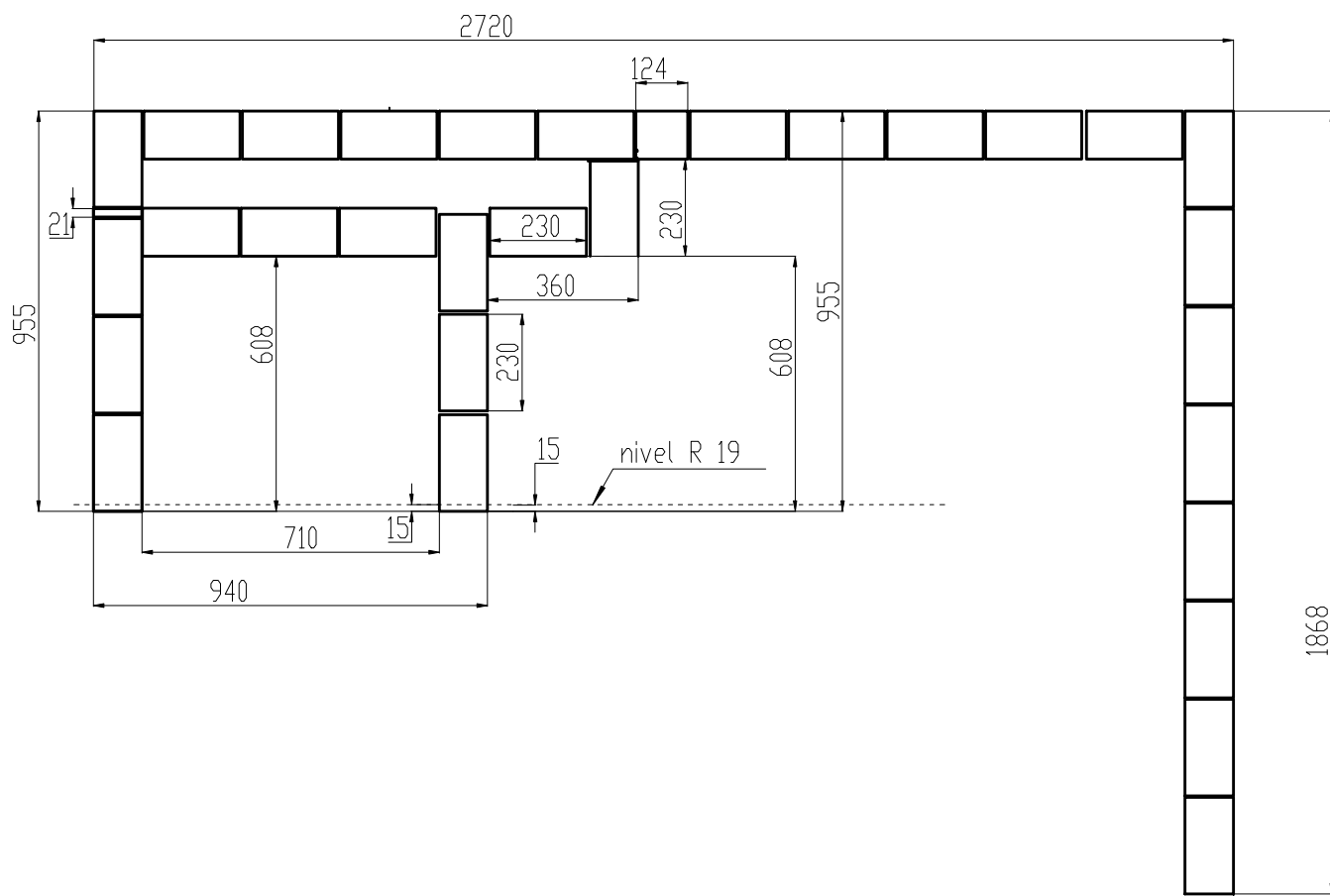

Randul 19

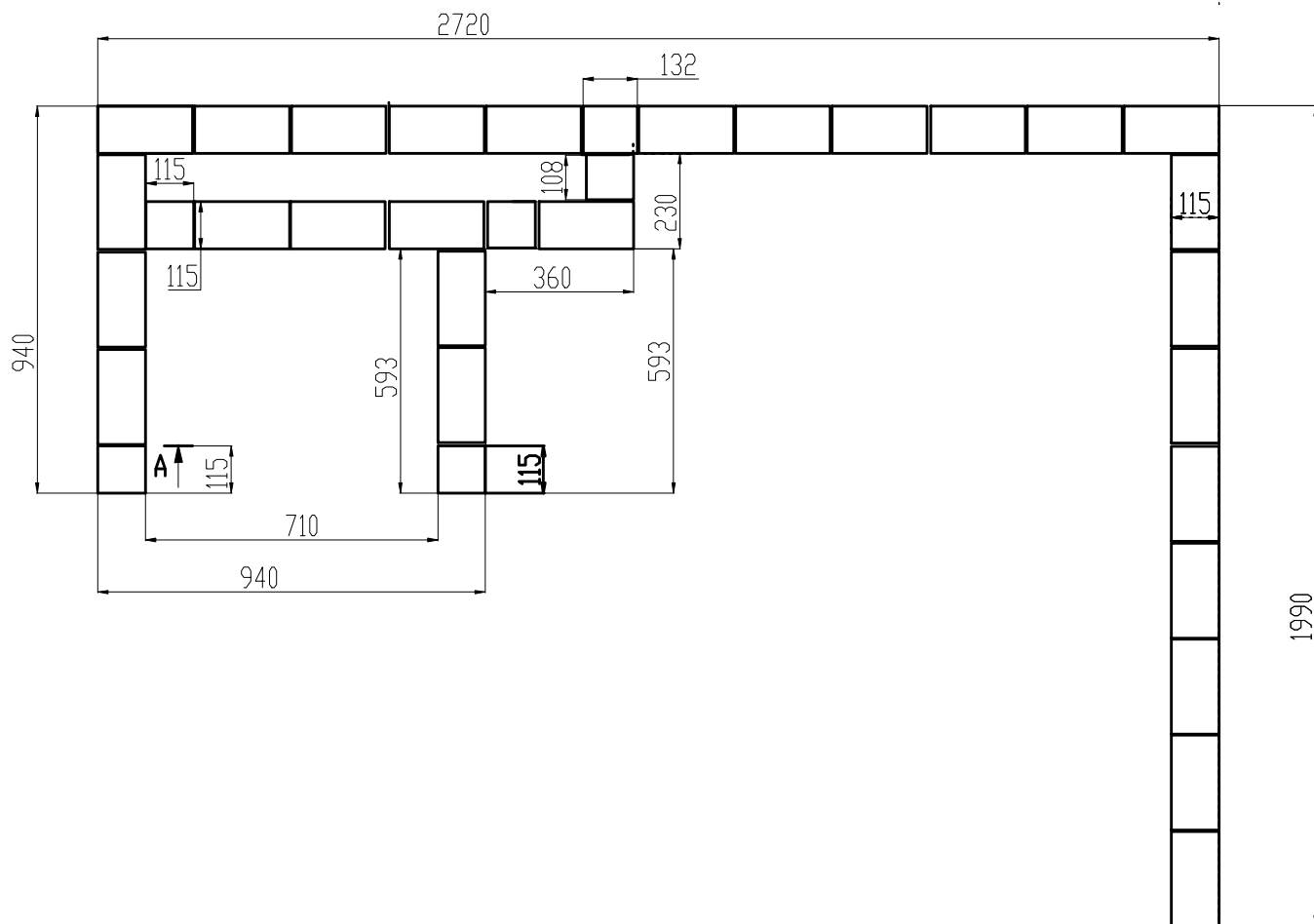

Randul 24

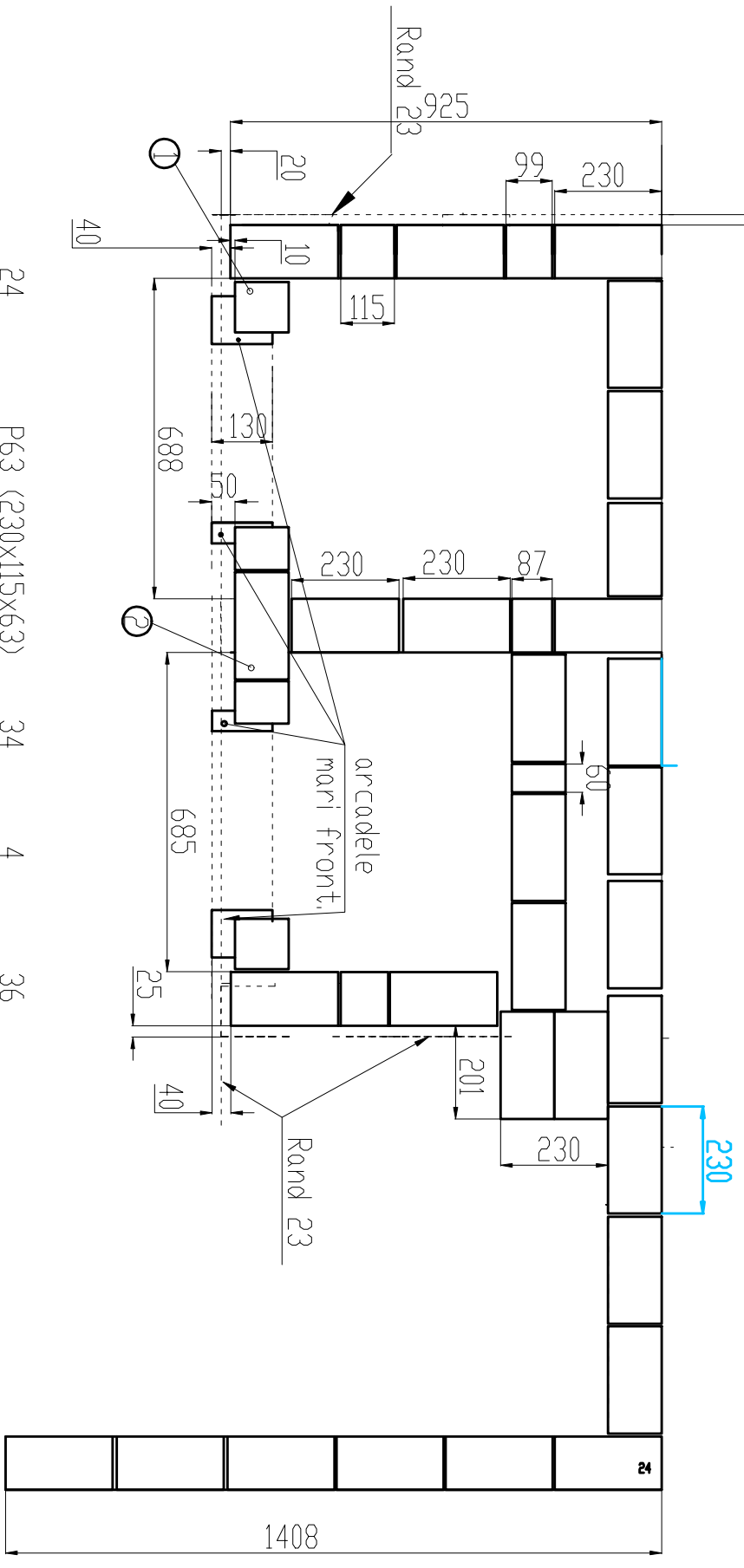
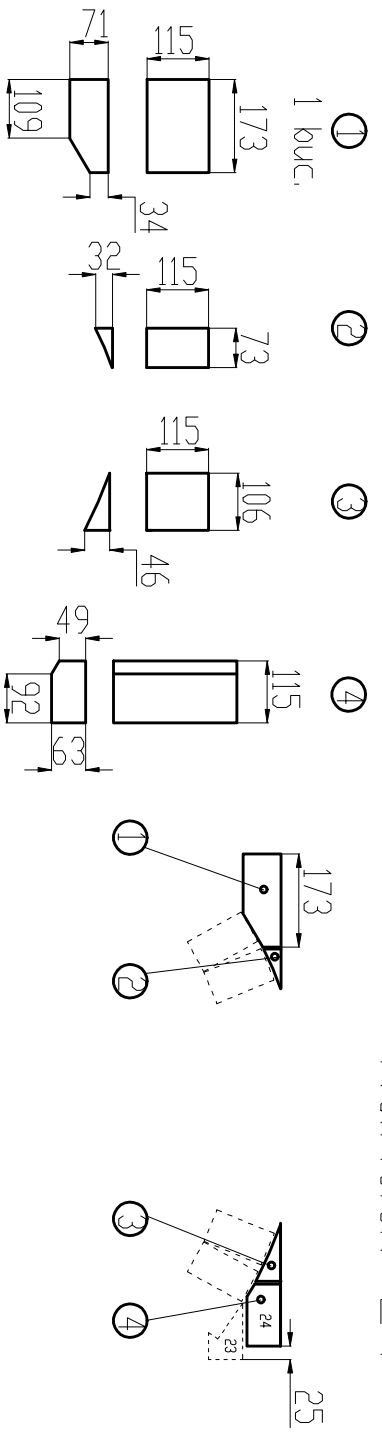

24 P63 (230x115x63) 34 4 36

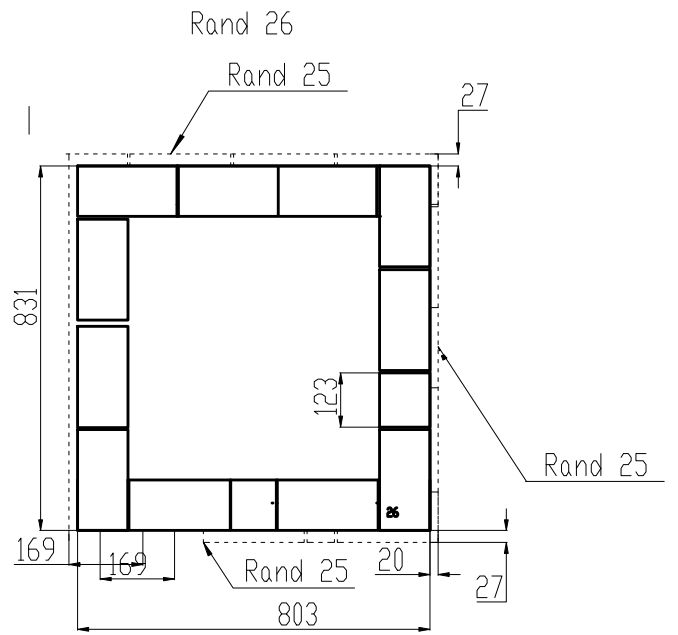
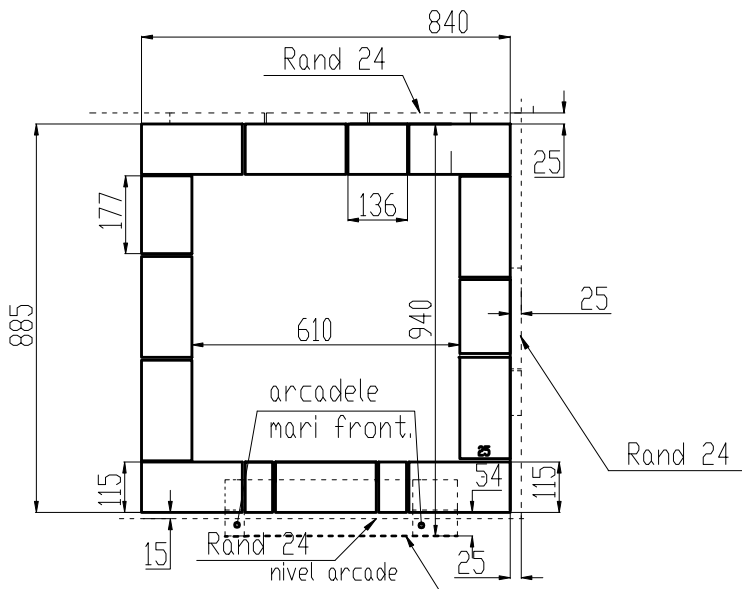
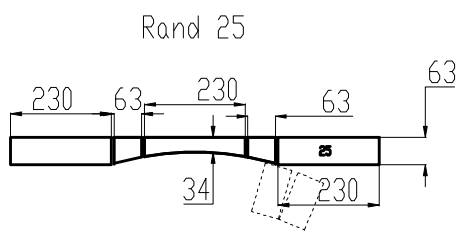
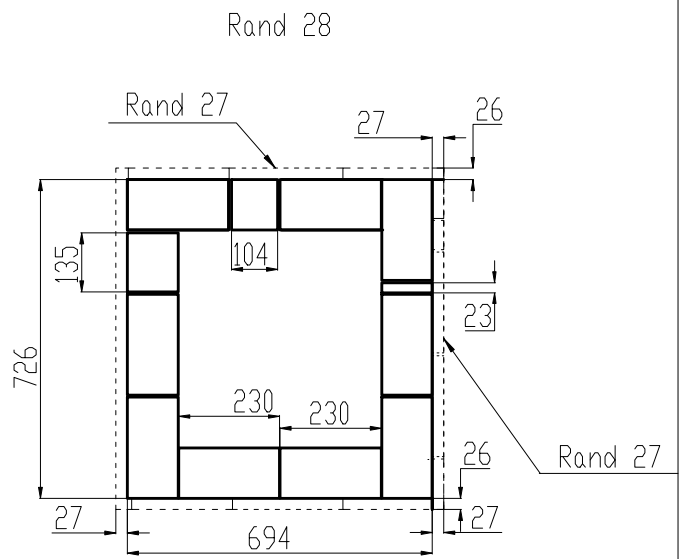
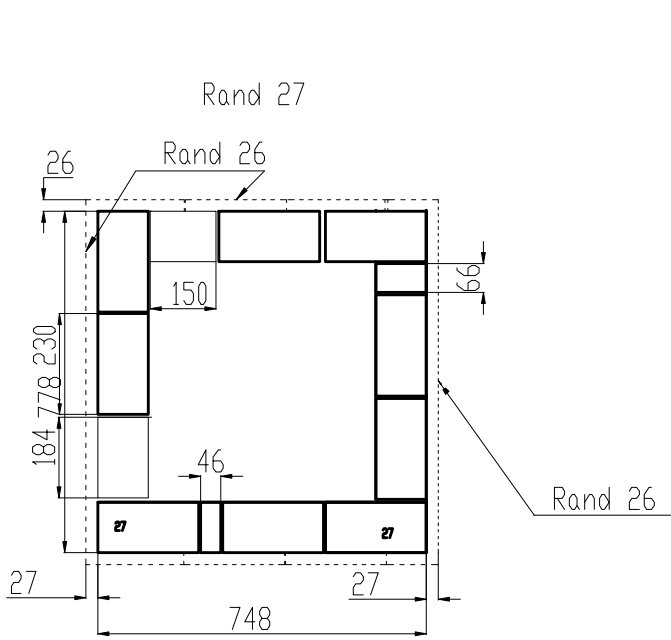

Rand 31

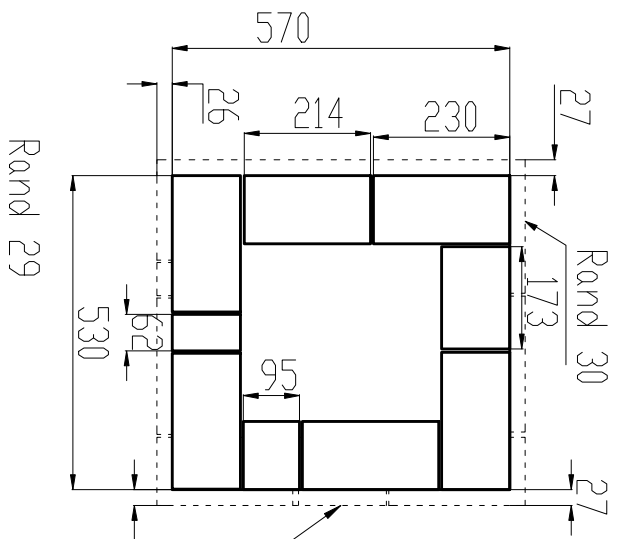

Rand 32

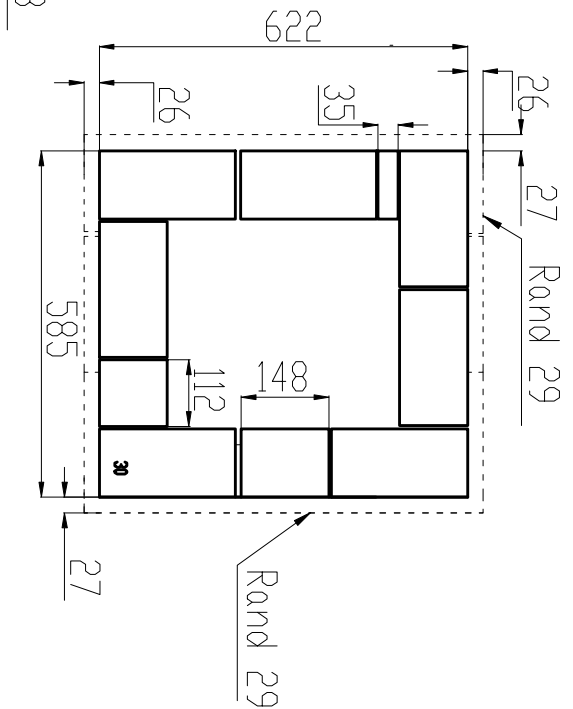
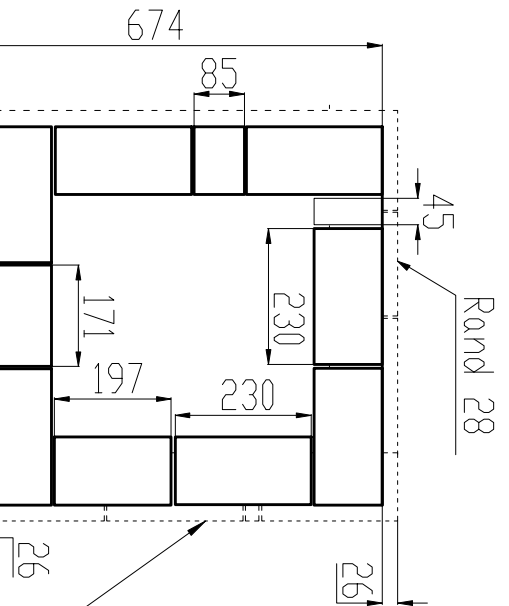
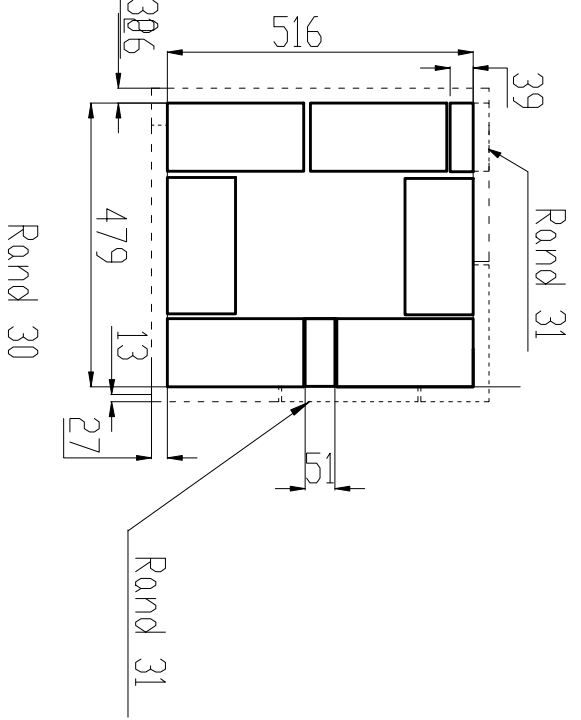

Rand 35,39,
43.

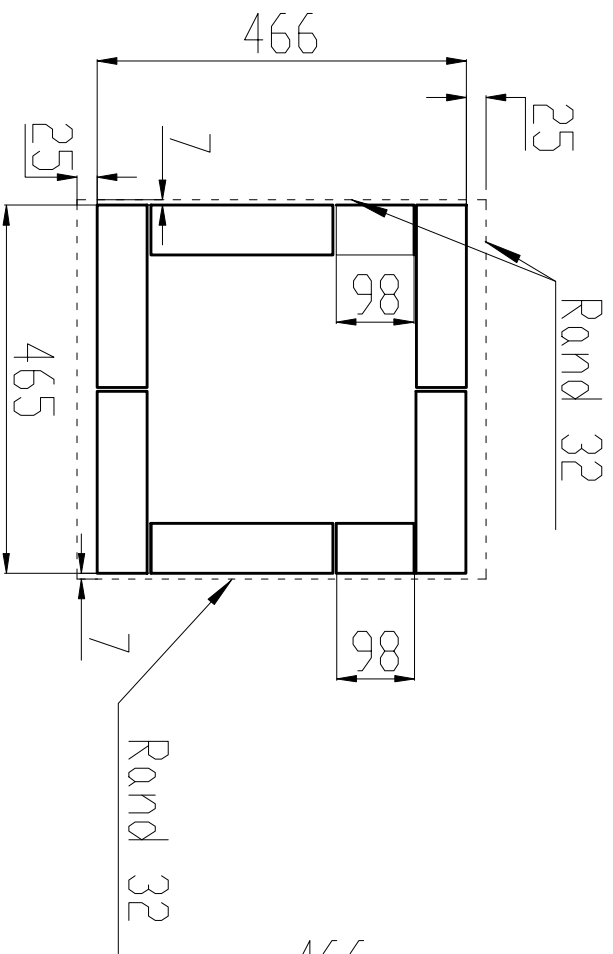
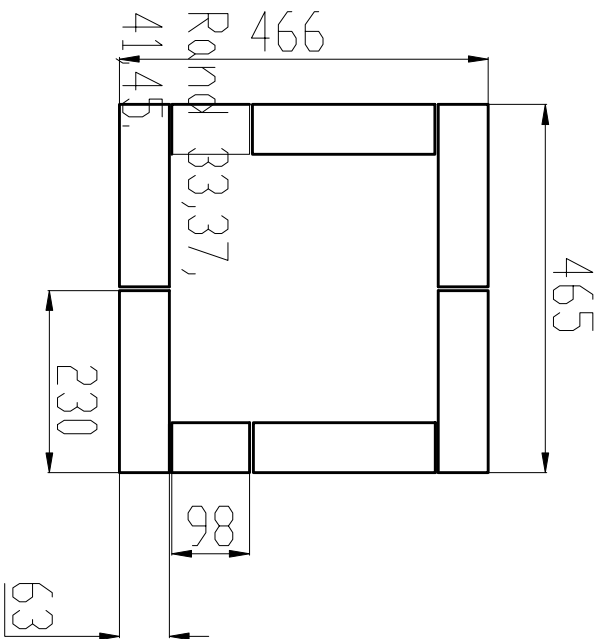

Rand 46

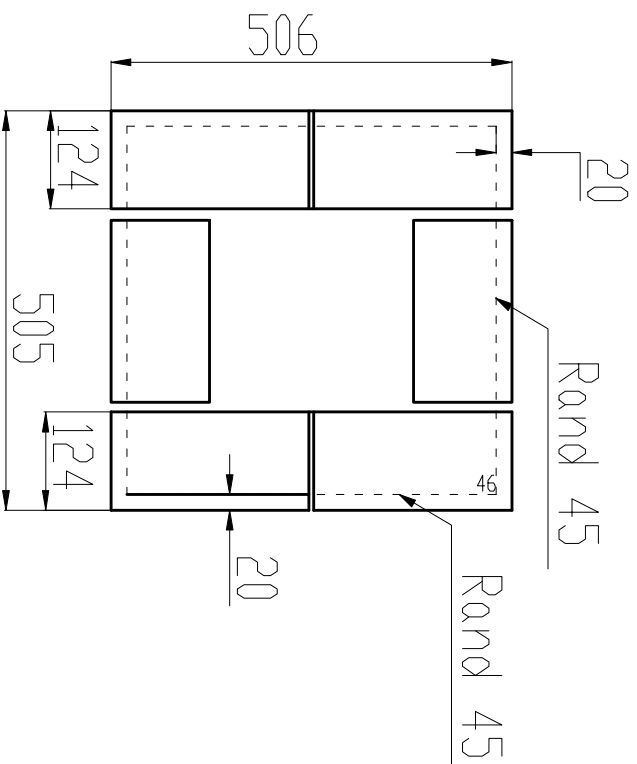

Rand 34,36,
38,40,42,44.

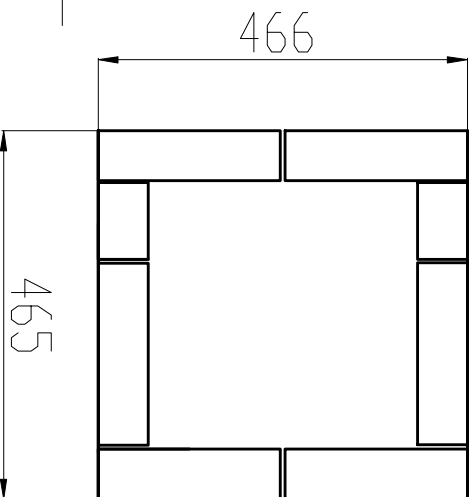

Lista de caramizi varianta 4
Grill+plita+chiuveta

Caramizi P63 (230x115x63)

Nr. rand	Nr. caramizi
1	122
2	45
3	44
4	46
5	48
6	46
7	43
8	67
9	47
10	48
11	47
12	61
13	40
14	36
15	40
16	35
17	40
18	32
19	40
20	31
21	33
22	44
23	33
24	40
25	16
26	13
27	14
28	11
29	11
30	10
31	9
32	7
33	8
34	8
35	8
36	8
37	8
38	8
39	8
40	8
41	8
42	8
43	8
44	8
45	8

Total 1273 buc.

Caramizi R-28 AS

Nr. rand	Nr. caramizi
13	18
2	25

Total 43

Caramizi 2R-28 AS

Nr. rand	Nr. caramizi
46	6

Total 6 buc.